



# Product catalogue

Mechanical locking system **3KSplus**

## System characteristics

The 3KS (3 curve system) is a reversible key system that distinguishes itself by virtue of its unique springless function principle. Unlike classic locking systems, locking elements in the 3KS cylinder move along the curves of the key under positive control, not pushed by spring force. This ensures the best wear resistance and picking protection. Thanks to the enormous number of possible variations, complex master key systems can be calculated and unusual lock authorisation requests can be fulfilled. 3KS cylinders in Euro profile are manufactured modularly, thus an on-site length adaptation can be made anytime.

### Key copying protection

- Organisational protection through a legitimating procedure for key orders.
- Legal protection through patents and industrial property rights
- Technical protection through sophisticated curve pattern

### Cylinder Security

- Picking protection
- Drilling protection through hard metal elements in the body and plug
- Pulling protection
- Bump-key protection

Length deviations of 0.5 mm per cylinder side possible.



## Table of Contents

Keys	2
Double cylinders	6
Thumbturn cylinders	16
Half cylinders	21
Round cylinders	23
Padlocks	26
Cam locks and switch cylinders	31
Cabinet cylinders	46
Rim cylinders	59
Portal cylinders	64
EMZY	66
Country-specific cylinders	67
Cam types	78
Accessories	80

## Standard Key

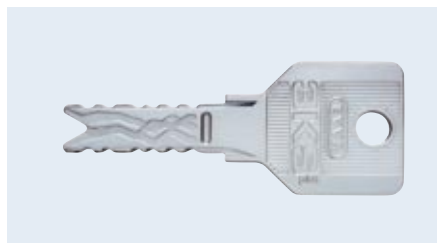

### Ordering information

- SL [system and key number]

### Technical data

- Key made of an extremely durable nickel silver alloy

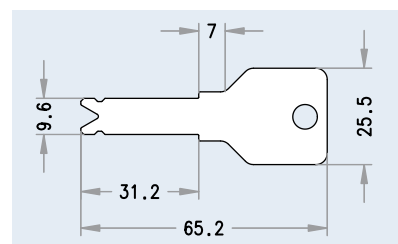

## Key With Colour Dot

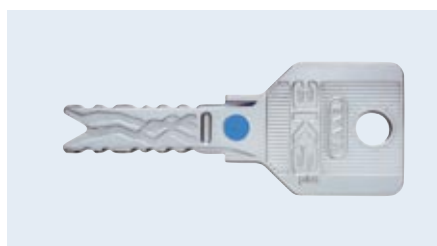

### Ordering information

- SL [system and key number]
- Colour dot [colour]: red, blue, green, yellow, brown, black, ice green, violet, dark red, aubergine, pink

### Technical data

- Key made of an extremely durable nickel silver alloy
- Recessed colour dot on key neck

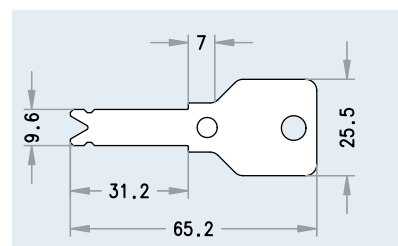

## Key With Elongated Neck

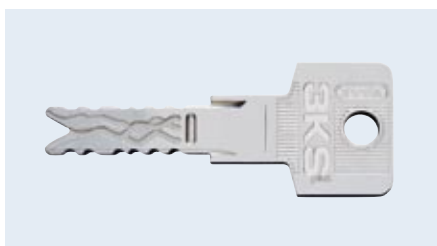

### Ordering information

- SLLH [system and key number]

### Technical data

- Specially shaped key made of a durable nickel silver alloy for use with armoured security escutcheons

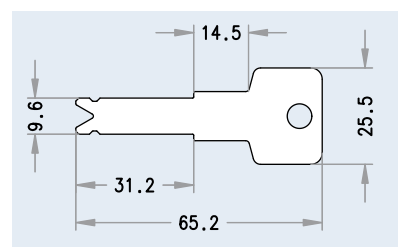



## Key With Plastic Cap



### ■ Technical data

- ▶ Key made of an extremely durable nickel silver alloy
- ▶ Key cap made of plastic, colour: anthracite
- ▶ Key upper section made of plastic, colour: red, blue, yellow, green.

### Ordering information

- ▶ SLKA [system and key number]
- ▶ Unless otherwise specified, key has anthracite colour or key upper section in red, blue, green, yellow

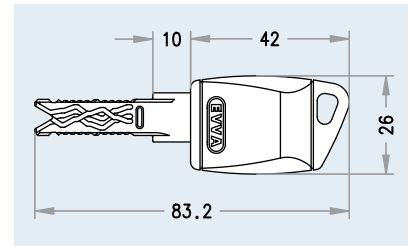

## Key With Additional Numbering



### ■ Technical data

- ▶ Customised inscription (in addition to system number and key number), e.g. "Mom"
- ▶ Consecutive numbering of keys (keys with identical authorisations receive consecutive number)
- ▶ Key made of an extremely durable nickel silver alloy

### Ordering information

- ▶ SL [system and key number] designation/number as required by customer; up to 18 characters if technically possible (no special characters)

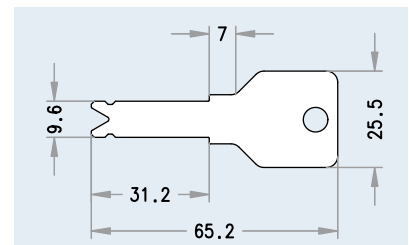

## Proximity Combi-key



### Ordering information

- ▶ SL [system and key number] CCM1KES (MIFARE 1k, anthracite)
- ▶ SL [system and key number] CCM4KES (MIFARE 4k, anthracite)
- ▶ SL [system and key number] CCD4KES (Desfire 4k, anthracite)
- ▶ SL [system and key number] CCL1KES (Legic 1k, anthracite)
- ▶ Red or yellow cap colour available

### Technical data

- ▶ Key with integrated electronic identification medium (contactless)
- ▶ Key bow made of durable polycarbonate, colour: anthracite

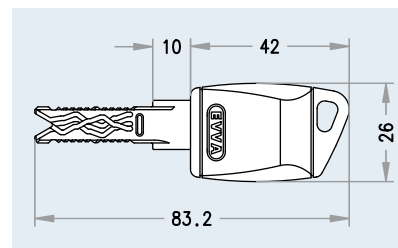

## iButton Combi-key



### Ordering information

- ▶ SL [system and key number] CEIRWES (iButton R/W 512B)

### Technical data

- ▶ Key with integrated electronic identification medium (touch-sensitive)
- ▶ Key bow made of durable polycarbonate, colour: anthracite

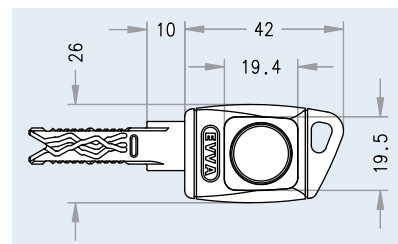

## Combi-key Upgrade Models



### Ordering information

- SL [system and key number] CE000TS

### Technical data

- Key is designed to integrate electronic upgrade media (contactless and touch-sensitive)
- Key bow made of durable polycarbonate, without electronics, colour: anthracite
- Key can be retrofitted with an electronic medium by the customer

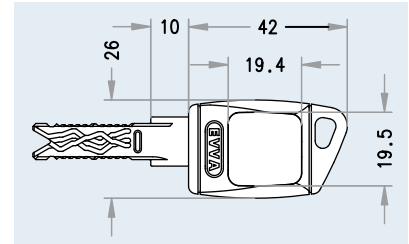

## MIFARE 1 K/Legic 1 K Combi-key Upgrade Medium



### Ordering information

- CMM1KE0
- CML1KE0

### Technical data

- Key cover with integrated electronic identification medium for use in Combi-key upgrade models
- MIFARE 1 K identification medium
- Legic 1 K identification medium

## iButton R/W 512 B Combi-key Upgrade Medium



### Ordering information

- CMIRWE0

### Technical data

- Key cover with integrated electronic identification medium for use in Combi-key upgrade models
- iButton R/W 512 B identification medium

## DZ Double Cylinder



### Ordering information

- DZ cylinder length A/B, [finish], [security and usage options]

### Applications and usage

- For mortise locks in accordance with DIN or ÖNORM
- For mortise locks in accordance with European technical standards
- For mortise locks with profile cylinder hole

### Functional characteristics

- Lockable on both sides with key
- Cam rotation: 360 degrees
- Cam removal position: 30 degrees (from the short side)

### Security features

- Hard metal drilling protection in plug and body
- Pulling protection due to chrome-nickel connecting rod
- Vertical key insertion and optimal scanning of locking elements

### Technical data

- Cylinder body base material: brass
- Cylinder plug base material: nickel silver
- All scanning elements coated with Triflon
- Cam home position: 30 degrees
- Cam width: 9.3 mm
- Modular cylinder design

### Scope of supply

- Locking cylinder with fixing screw

### Installation & operation

- Easy cylinder installation in a prepared, empty cylinder hole
- Cylinder projecting length may not exceed 3 mm for security-relevant doors
- Cylinder fixed through a M5 fastening hole

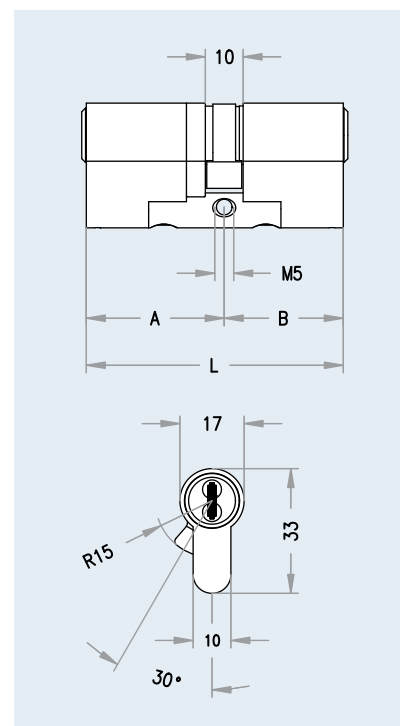

### Cylinder lengths

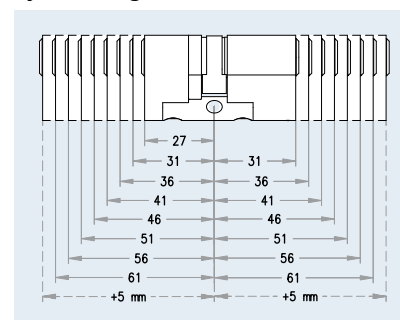

Cylinder length 27/31 not possible!

### Finishes

Finishes	Abbreviations	Standard	Surcharge
Polished brass	PB	●	
Satin nickel	NI	●	
Polished nickel	PN		○
Satin chrome	CR		○
Polished chrome	PC		○
Black	BL		○
Brown	BW		○
Satin brass	BR		○
PVD	PVD		○

## DZ Double Cylinder | Options



### BSZ - double cylinder with external key override, danger function for double cylinder

Permits operation of the cylinder even when an authorised key is inserted in the opposite side.

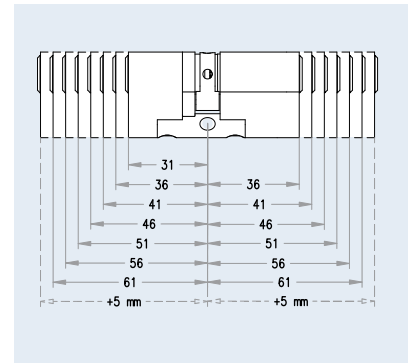

#### Ordering information

- DZ cylinder length A/B, [finish] BSZ



### KZS – special drilling and pulling protection

Plug pulling with special tools is prevented by special hard metal pins. Increased drilling protection is also provided. KZS protects against visible opening methods and exceeds the protective goals of norms.

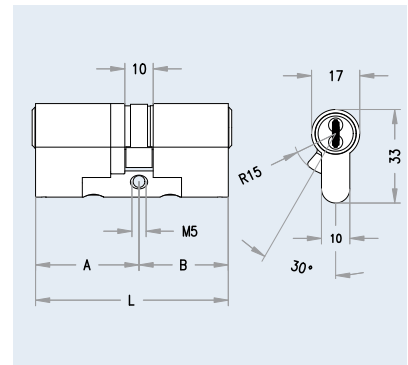

#### Ordering information

- DZ cylinder length A/B, [finish] KZS-.- KSZ-ES (one sided, with symmetric cylinders)
  - KZS-BS (both sides)
  - KZS-KS (short side)
  - KZS-LS (long side)



### SSW – protection mechanism against dust and weathering influences (dust cover)

Spring-loaded shutter plates integrated into the cylinder that automatically open or close when the key is inserted or removed.

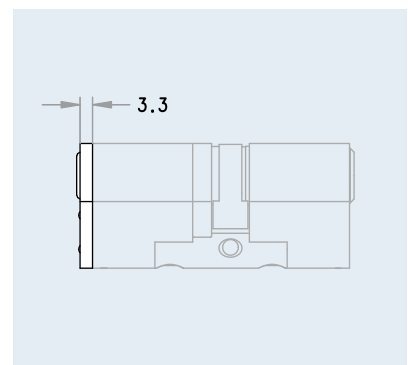

#### Ordering information

- DZ cylinder length A/B, [finish]
  - SSW-BS (both sides)
  - SSW-ES (one sided, with symmetric cylinders)
  - SSW-KS (short side)
  - SSW-LS (long side)

## DZ Double Cylinder | Options



### Ordering information

- DZ cylinder length A/B, [finish]  
SEW

### SEW - seawater resistant model

For cylinders exposed to more severe environmental influences. Corrosion-susceptible cylinder parts are supplied with a special surface treatment.

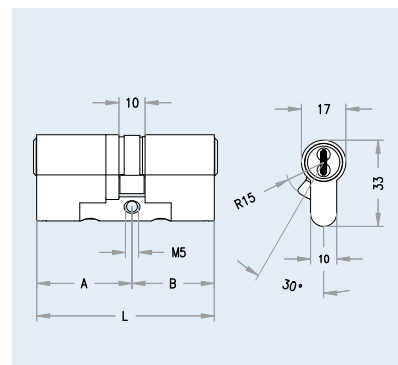

### Ordering information

- DZ cylinder length A/B, [finish]  
VdS

### VdS-cylinder

VdS-certified cylinder for installation in high-security areas.  
Increased resistance to visible and non-visible opening techniques.  
VdS-cylinders are manufactured according to the currently valid VdS-guidelines.



### Ordering information

- DZ cylinder length A/B, [finish] ZR10

### ZR10 cog-wheel cam (10 teeth)

The cylinder is designed for multi-point locks or special mortise locks that are operated via a gear ring or a toothed rack.

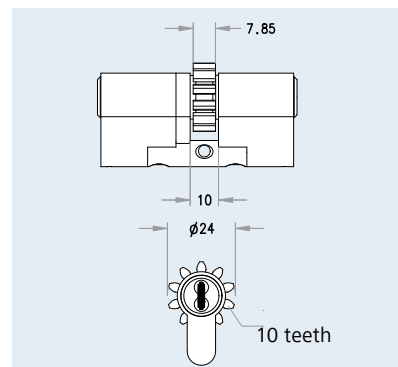

## DZ Double Cylinder | Options



### ZR18 cog-wheel cam

(18 teeth)

The cylinder is designed for multi-point locks or special mortise locks that are operated via a gear ring or a toothed rack.

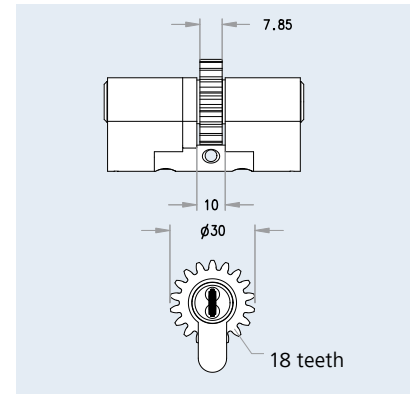

#### Ordering information

- DZ cylinder length A/B, [finish] ZR18



### BIF double cam

The cylinder is designed for manufacturer-specified locks in Biffar doors.

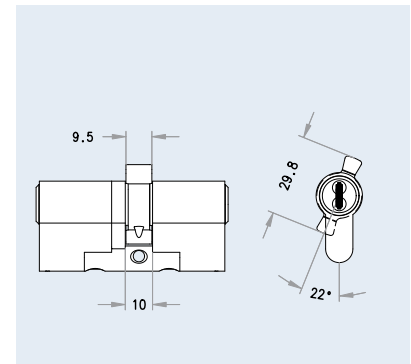

#### Ordering information

- DZ cylinder length A/B, [finish] BIF
- Cam position: 22 degrees, from short cylinder side
- Please observe the door manufacturer's instructions!



### STEN star cam

The cylinder is designed for ABUS bar locks types PR1500 & PR1600.

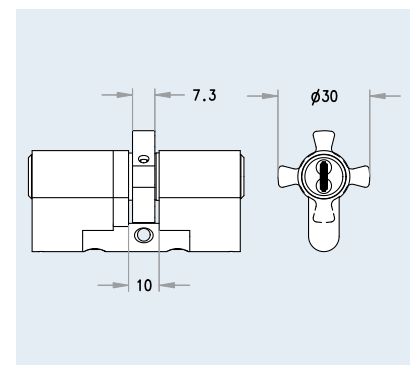

#### Ordering information

- DZ cylinder length A/B, [finish] STEN

## DZ Double Cylinder | Options



### Ordering information

- DZ cylinder length A/B, [finish] Vario

### VAR - Vario, construction keying

If an authorised key is lost or stolen, the cylinder can be mechanically recoded with the Vario B key in such a manner that the lost/stolen key cannot operate the cylinder anymore.

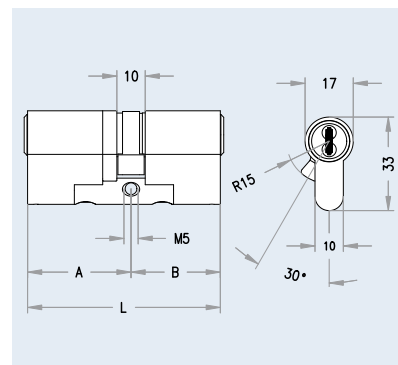

### Ordering information

- DZ cylinder length A/B, [finish] GEFE

### GEFE – emergency key feature

A special emergency key can operate the cylinder even when an authorised key is inserted on the opposite side.

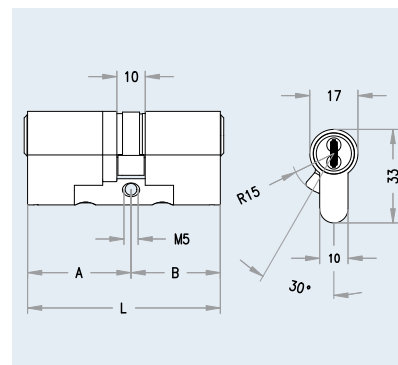

### Ordering information

- DZ cylinder length A/B, [finish] ZVS-(ES/LS/KS)
- ZVS-ES (one sided, with symmetric cylinders)
- ZVS-LS (long side)
- ZVS-KS (short side)

### Double cylinder with shortened body

Cylinder with shortened body, also for use in special metal-frame doors with integrated security rose.

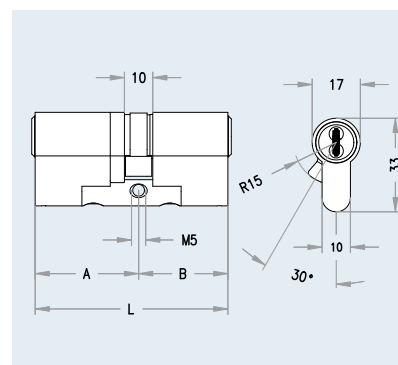



## DZ Double Cylinder | Options



### PA partner cylinder

The cylinder can only be operated when an authorised key is inserted on the opposite side.

#### Ordering information

- DZ cylinder length A/B, [finish]  
PA

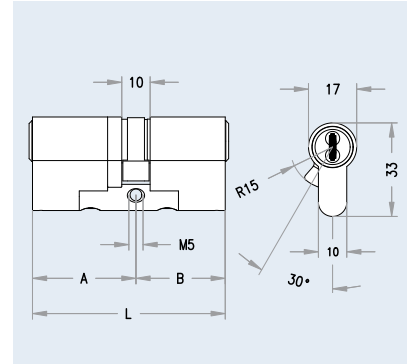

### USH differing locking hierarchy

The cylinder has different A/B hierarchic authorisation levels, e.g. the outside can only be operated by a super-ordinate key while the inside can be operated with any authorised key.

#### Ordering information

- DZ cylinder length A/B, [finish] USH;
- Specification of locking authorisations per cylinder side (A/B)

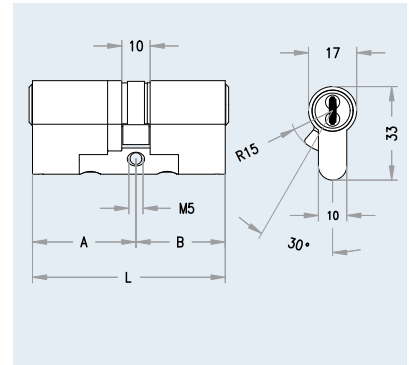

### FL2 - double cylinder with free-wheel function

Cylinder with 360 degree free-wheeling cam when key is not inserted. Coupling engaged when the key tip is inserted.

#### Ordering information

- DZ cylinder length A/B, [finish], FL2

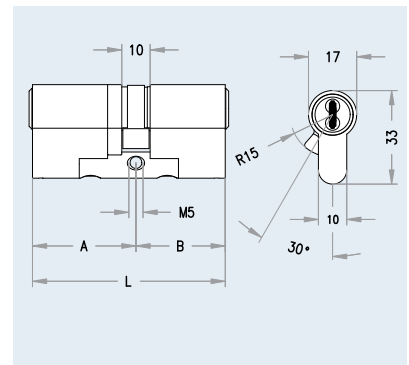

## DZ Double Cylinder | Options



### Double cylinder with free-wheel function and positive decoupling

Cylinder with 360 degree free-wheeling and positive-action decoupling of the cam. Coupling engaged when the key tip is inserted.

Special cam design.

Suitable for geared-lock anti-panic multiple locking.

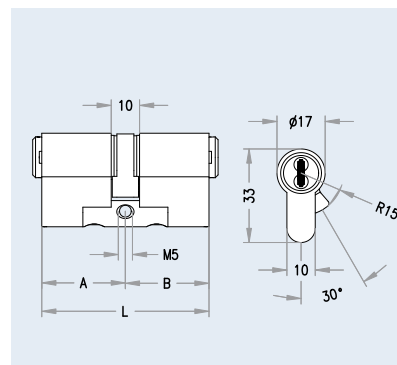

## Ordering information

- DZ cylinder length A/B, [finish]  
EZG

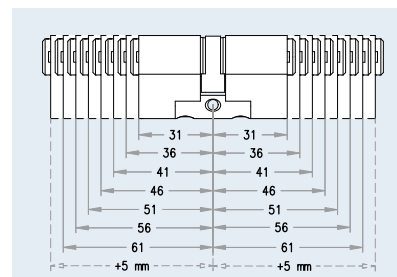

## Options overview

ARS possible only in compact design

Vario possible only in compact design

S = Standard

- simple combination possible

[illegible]

## DZ Double Cylinder | Options



### Double cylinder, slot on one side

Can be operated with an authorised key on one side and with a flat object on the Flex side.

Cam rotation is 360 degrees and cam removal position is 30 degrees (from the short side).

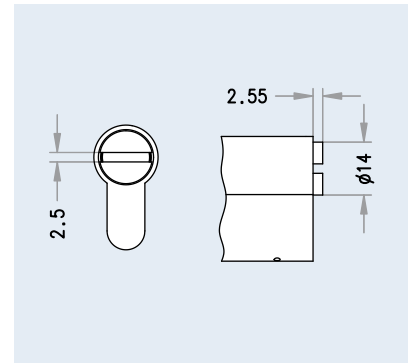

### Ordering information

- DZ cylinder length A/B, [finish] Flex S-(ES/LS/KS)
- Flex S-ES (one sided, with symmetric cylinders)
- Flex S-LS (long cylinder side)
- Flex S-KS (short cylinder side)



### Double cylinder, Allen socket on one side

Can be operated with an authorised key on one side and with a SW6 Allen key on the Flex side.

Cam rotation is 360 degrees and cam removal position is 30 degrees (from the short side)

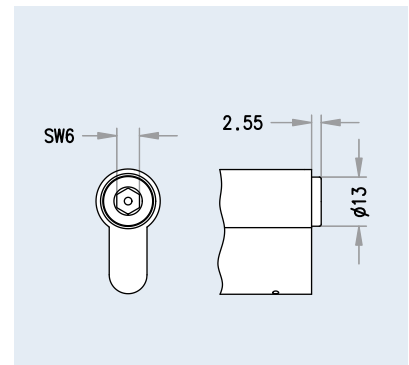

### Ordering information

- DZ cylinder length A/B, [finish] (ES/LS/KS) [security, application and convenience options]
- Flex I6-ES
- Flex I6-LS
- Flex I6-KS



### Double cylinder, square socket on one side

Can be operated with an authorised key on one side and with an 8 mm square socket key on the Flex side.

Cam rotation is 360 degrees and cam removal position is 30 degrees (from the short side).

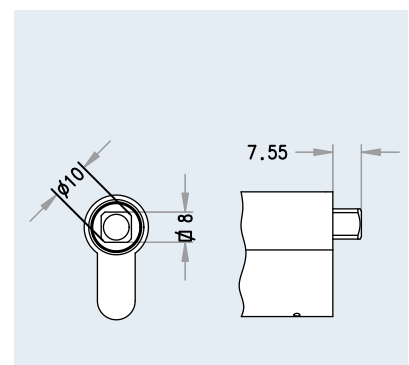

### Ordering information

- DZ cylinder length A/B, [finish] (ES/LS/KS) [security, application and convenience options]
- Flex 4K-ES
- Flex 4K-LS
- Flex 4K-KS

## DZ Double Cylinder | Options



### Double cylinder, 8 mm three-square socket on one side

Can be operated with an authorised key on one side and with an 8 mm three-square key on the Flex side.

Cam rotation is 360 degrees and cam removal position is 30 degrees (from the short side)

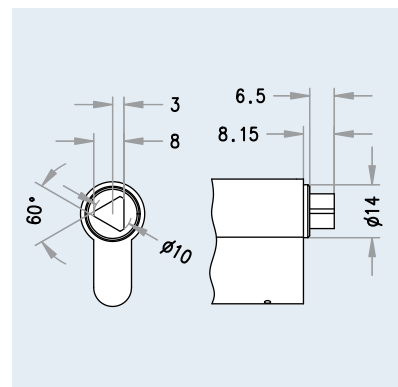

### Ordering information

- DZ cylinder length A/B, [finsh] (ES/LS/KS) [security, application and convenience options]
- Flex D8-ES
- Flex D8-LS
- Flex D8-KS



### Double cylinder, 11 mm three-square socket on one side

Can be operated with an authorised key on one side and with an 11 mm three-square key on the Flex side.

Cam rotation is 360 degrees and cam removal position is 30 degrees (from the short side)

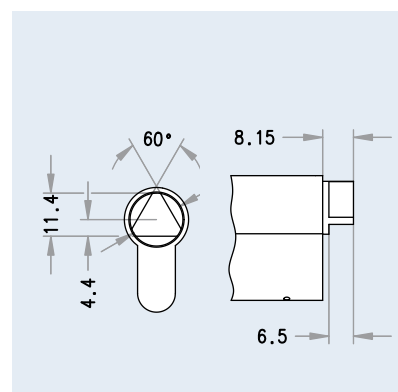

### Ordering information

- DZ cylinder length A/B, [finsh] (ES/LS/KS) [security, application and convenience options]
- Flex D11-ES
- Flex D11-LS
- Flex D11-KS



### Double cylinder, 14 mm three-square socket on one side

Can be operated with an authorised key on one side and with an 14 mm three-square key on the Flex side.

Cam rotation is 360 degrees and cam removal position is 30 degrees (from the short side).

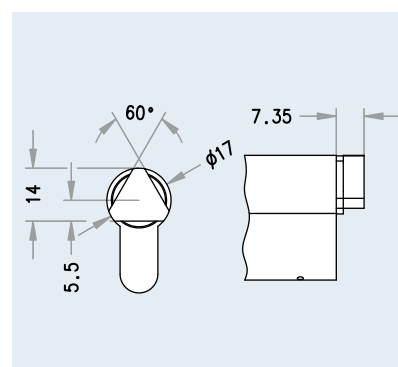

### Ordering information

- DZ cylinder length A/B, [finsh] (ES/LS/KS) [security, application and convenience options]
- Flex D14-ES
- Flex D14-LS
- Flex D14-KS

## DZ Double Cylinder | Options



### Double cylinder, blind on one side

Can be operated with an authorised key on one side.

Other cylinder side is blind, cannot be operated.

Cam rotation is 360 degrees and cam removal position is 30 degrees (from the short side).

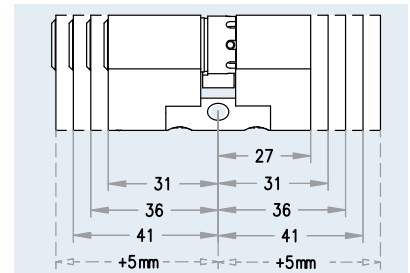
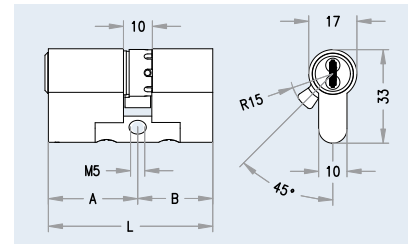

### Ordering information

- DZ cylinder length A/B, [finish], Flex BL-(ES/LS/KS)
- Flex BL-ES (one sided, with symmetric cylinders)
- Flex BL-LS (long cylinder side)
- Flex BL-KS (short cylinder side)



### Double cylinder, blind on both sides

Double cylinder is blind on both sides, mortise lock cannot be used.

For doors that must not be locked but where the cylinder hole must be sealed.

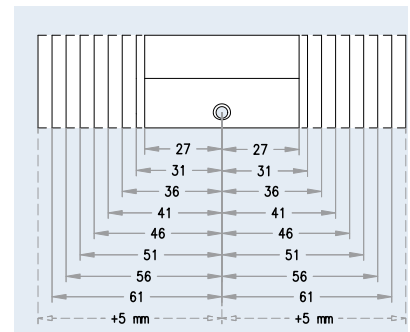
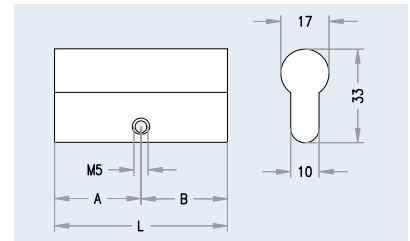

### Ordering information

- DZ cylinder length A/B, [finish], BLIND

## KZ Thumbturn Cylinder



### Ordering information

- KZ cylinder length A/B (A=outer side; B=inner side (thumbturn side)) [security and usage options]
- [finish]/[thumbturn design]
- When thumbturn design is not specified: AKN standard thumbturn

### Applications and usage

- For mortise locks in accordance with DIN or ÖNORM
- For mortise locks in accordance with European technical standards
- For house doors, connecting doors, flat entry doors, security doors, metal frame doors, ...
- For break-in resistant doors of resistance class Wz6

### Functional characteristics

- Can be locked from the outside with a key
- Thumbturn on the inside to lock and unlock the door
- Cam rotation: 360 degrees

### Security features

- Hard metal drilling protection in the outside plug and body
- Pulling protection through chrome-nickel connecting rod
- Vertical key insertion for optimal scanning of locking elements

### Technical data

- Cylinder body base material: brass
- Cylinder plug base material: nickel silver
- All scanning elements coated with Triflon
- Cam home position: 30 degrees
- Cam width: 9.3 mm
- Modular cylinder design
- Finishes: satin nickel plated, satin brushed, polished lacquer

### Scope of supply

- Locking cylinder with thumbturn and fixing screw

### Installation & operation

- Easy cylinder installation in a prepared, empty cylinder hole
- Cylinder projecting length may not exceed 3 mm for security-relevant doors
- If required, inside thumbturn can be removed with a tool and replaced with another EVVA thumbturn
- Cylinder fixed through a M5 fastening hole

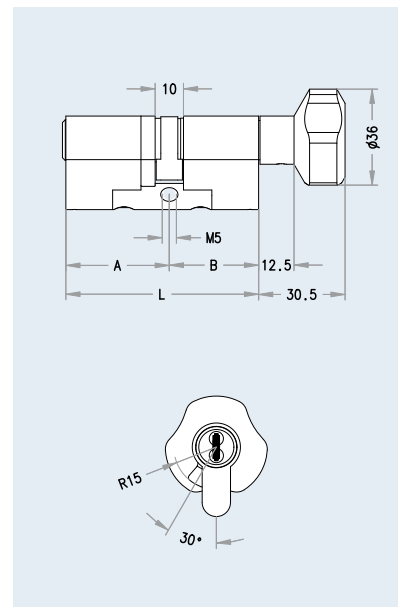

### Cylinder lengths

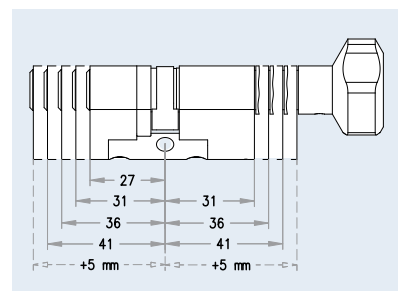

### Finishes

Finishes	Abbreviations	Cylinder	AKN	KKN	FKN	OKN	OKNA	GKN
Polished brass	PB	●	●	●	●	●	●	●
Satin nickel	NI	●	●	●	●	●	●	●
Polished nickel	PN	○	○	○	○	○	○	○
Satin chrome	CR	○	○	○	○	○	○	○
Polished chrome	PC	○	○	○	○	○	○	○
Black	BL	○	○	○	○	○	○	○
Brown	BW	○	○	○	○	○	○	○
Satin brass	BR	○	○	○	○	○	○	○
PVD	PVD	○	○	○	○	○	○	○
RAL colour	RAL	○	○	○	○	○	○	○

## AKN Standard Thumbturn

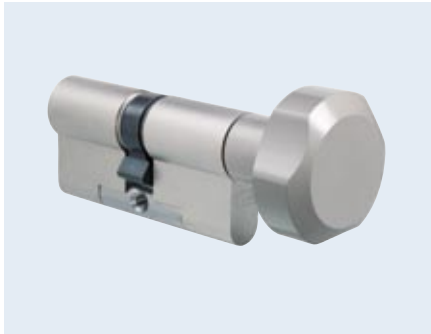

### Ordering information

- ▶ KZ cylinder length A/B (A=outer side; B=inner side (thumbturn side)) [security and usage options]
- ▶ [finish]/AKN

### Functional characteristics

- ▶ Removable thumbturn with three grip recesses

### Technical data

- ▶ Base material: brass
- ▶ Finishes: satin nickel plated, satin brushed, polished lacquer

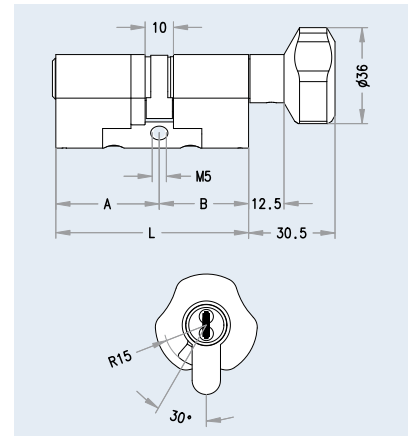

## KKN Conical Thumbturn



### Ordering information

- ▶ KZ cylinder length A/B (A=outer side; B=inner side (thumbturn side)) [security and usage options]
- ▶ [finish]/KKN

### Functional characteristics

- ▶ Removable, cone-shaped thumbturn with grip recesses

### Technical data

- ▶ Base material: brass
- ▶ Finishes: satin nickel plated, satin brushed, polished lacquer

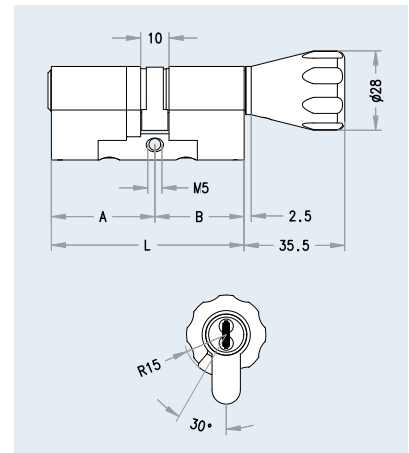

## RKN Round Thumbturn

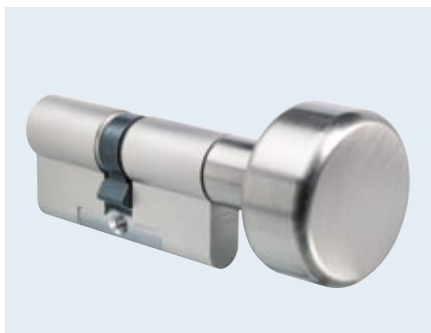

### Ordering information

- ▶ KZ cylinder length A/B (A=outer side; B=inner side (thumbturn side)) [security and usage options]
- ▶ [finish]/RKN

### Functional characteristics

- ▶ Removable, round thumbturn set off to the rear

### Technical data

- ▶ Base material: brass
- ▶ Finishes: satin nickel plated, satin brushed, polished lacquer

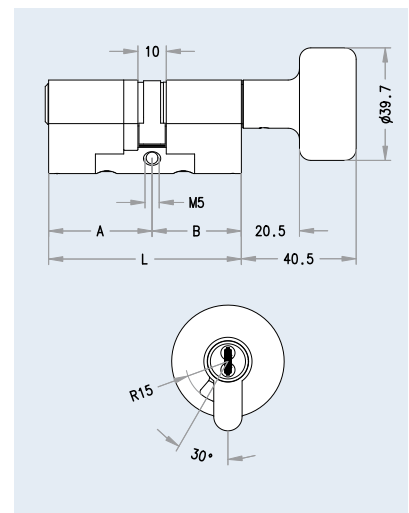

## MKN Knurled Metal Thumbturn

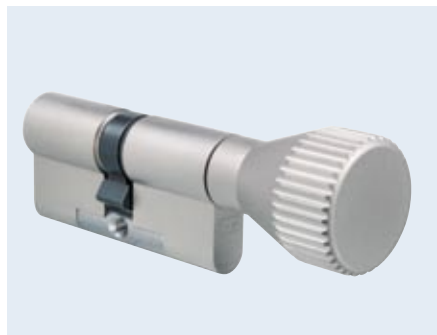

### Functional characteristics

- ▶ Removable, knurled thumbturn with medium-sized serrations

### Technical data

- ▶ Base material: brass
- ▶ Finishes: satin nickel plated, satin brushed, polished lacquer

### Ordering information

- ▶ KZ cylinder length A/B (A=outer side; B=inner side (thumbturn side)) [security and usage options]
- ▶ [finish]/MKN

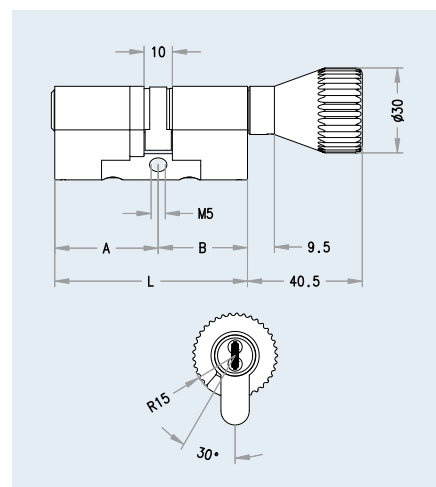

## GKN Recessed Grip Thumbturn



### Functional characteristics

- ▶ Removable, round thumbturn set off to the rear

### Technical data

- ▶ Base material: brass
- ▶ Finishes: satin nickel plated, satin brushed, polished lacquer
- ▶ Or lacquered in RAL colours: blue RAL5002; dark green RAL6012; yellow RAL1004; green RAL6001; grey RAL7038; red RAL3003; black RAL9005; white RAL 9010; other RAL colours on request

### Ordering information

- ▶ KZ cylinder length A/B (A=outer side; B=inner side (thumbturn side)) [security and usage options]
- ▶ [finish]/GKN

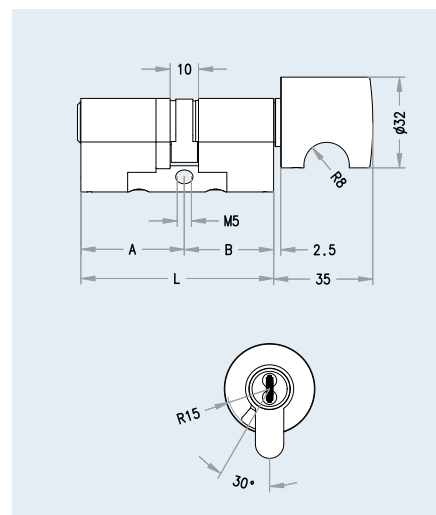

## FKN Flat Thumbturn



### Functional characteristics

- ▶ Stylishly shaped, removable, flat thumbturn with 2 grip recesses
- ▶ Particularly suitable for the elderly and people with disabilities

### Technical data

- ▶ Base material: brass
- ▶ Finishes: satin nickel plated, satin brushed, polished lacquer

### Ordering information

- ▶ KZ cylinder length A/B (A=outer side; B=inner side (thumbturn side)) [security and usage options]
- ▶ [finish]/FKN

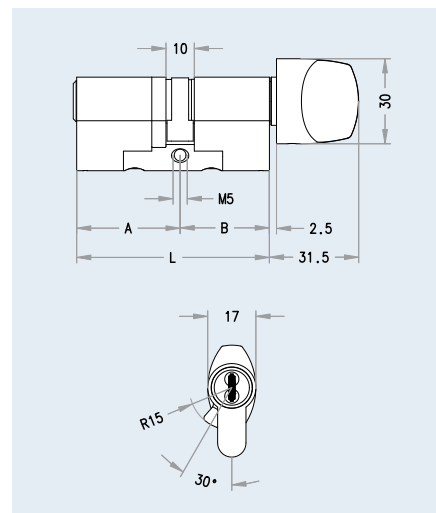



## OKN Oval Thumbturn



### Functional characteristics

- Removable, horizontal, light metal thumbturn with two grip recesses

### Technical data

- Base material: aluminium
- Finishes: satin nickel plated, F2 anodized, F3 anodized, polished gold colour

### Ordering information

- KZ cylinder length A/B (A=outer side; B=inner side (thumbturn side)) [security and usage options]
- [finish]/OKN

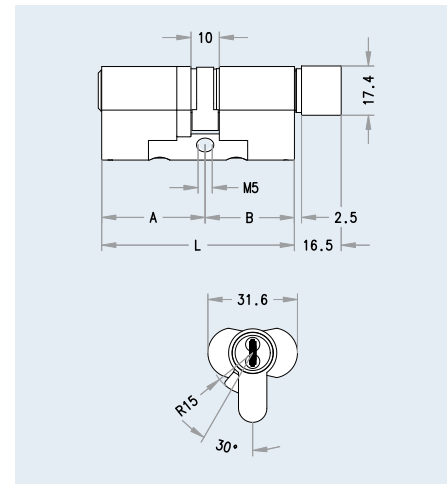

## OKNA Asymmetric Oval Thumbturn

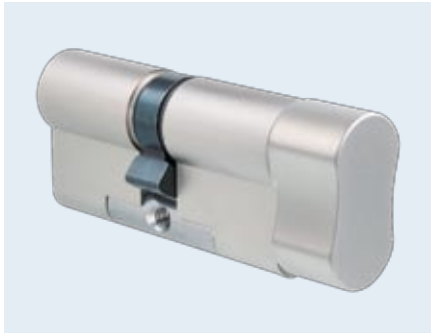

### Functional characteristics

- Removable, vertical, light metal thumbturn with two grip recesses

### Technical data

- Base material: aluminium
- Finishes: satin nickel plated, F2 anodized, F3 anodized, polished gold colour

### Ordering information

- KZ cylinder length A/B (A=outer side; B=inner side (thumbturn side)) [security and usage options]
- [finish]/OKNA

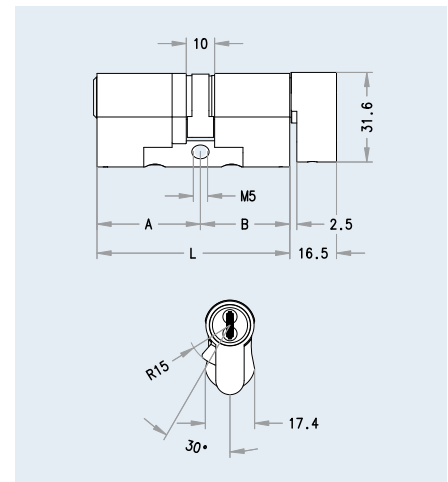

## Thumbturn Cylinders | Options



### Thumbturn cylinder with classroom function

The thumbturn side (inside area) can only be unlocked with the thumbturn. Locking from the inside (e.g. class rooms) is not possible. In addition the key side always has priority function. Thus the cylinder can also be operated from the outside e.g. when the thumbturn is held from the inside.

### Installation & operation

- Easy cylinder installation in a prepared, empty cylinder hole
- Adjustable for left/right doors
- Cylinder fixed through a M5 fastening hole

### Ordering information

- KZ cylinder length A/B, CLASS (A=outer side; B=inner side (thumbturn side))
- [finish]/[thumbturn design]
- When thumbturn design is not specified: AKN standard thumbturn

# Thumbturn Cylinders | Options



## Thumbturn cylinder with SOS function

The key-operated cylinder side is equipped with a priority function. The cylinder can even be operated from the outside when manipulated (e.g. when the thumbturn is being held on the inside).

## Further options

See DZ options

## Ordering information

- ▶ cylinder length A/B, SOS (A=outer side; B=inner side (thumbturn side))
- ▶ [Finish]/[thumbturn design]
- ▶ When thumbturn design is not specified: AKN standardthumbturn

## Options overview

ARS possible only in compact design,  
VAR possible only in compact design,  
S = Standard

- simple combination possible

		external key override	plug pulling protection	dust cover	sea water resistant	protection against breaking off	cylinder certified acc to VdS	wear resistance	cog wheel cam (10 teeth)	cog wheel cam (18 teeth)	Biffar double cam	star cam	construction keying	emergency function	priority function	hotel function	shortened body	partner function	differing locking hierarchy	free wheel cam	free wheel cam for geared lock	four-eyes principle
		BSZ	KZS	SSW	SEW	ARS	VDS	NS	ZR10	ZR18	BIF	STEN	VAR	GEFE	SOS	HOTE	ZVS	PA	USH	FREI	FZG	DUP
external key override	BSZ	-	-	-	-	-	-	-	-	-	-	-	-	-	-	-	-	-	-	-	-	-
plug pulling protection	KZS	-	-	-	●	-	S	S	●	●	●	●	●	-	●	-	●	-	-	-	-	-
dust cover	SSW	-	-	-	●	-	●	S	●	●	●	●	●	-	●	-	-	-	-	-	-	-
sea water resistant	SEW	-	●	●	-	-	●	S	●	●	●	●	●	-	●	-	●	-	-	-	-	-
protection against breaking off	ARS	-	-	-	-	-	-	-	-	-	-	-	-	-	-	-	-	-	-	-	-	-
cylinder certified acc to VdS	VDS	-	S	-	●	-	-	S	●	●	●	●	-	-	-	-	-	-	-	-	-	-
wear resistance	NS	-	S	S	S	-	S	-	S	S	S	S	S	-	S	-	S	-	-	-	-	-
cog wheel cam (10 teeth)	ZR10	-	●	●	●	-	●	S	-	-	-	-	●	-	●	-	●	-	-	-	-	-
cog wheel cam (18 teeth)	ZR18	-	●	●	●	-	●	S	-	-	-	-	●	-	●	-	●	-	-	-	-	-
Biffar double cam	BIF	-	●	●	●	-	●	S	-	-	-	-	●	-	●	-	●	-	-	-	-	-
star cam	STEN	-	●	●	●	-	●	S	-	-	-	-	●	-	●	-	●	-	-	-	-	-
construction keying	VAR	-	●	●	●	-	-	S	●	●	●	●	-	-	-	-	●	-	-	-	-	-
emergency function	GEFE	-	-	-	-	-	-	-	-	-	-	-	-	-	-	-	-	-	-	-	-	-
priority function	SOS	-	●	●	●	-	-	S	●	●	●	●	-	-	-	-	●	-	-	-	-	-
hotel function	HOTE	-	-	-	-	-	-	-	-	-	-	-	-	-	-	-	-	-	-	-	-	-
shortened body	ZVS	-	●	-	●	-	-	S	●	●	●	●	●	-	●	-	-	-	-	-	-	-
partner function	PA	-	-	-	-	-	-	-	-	-	-	-	-	-	-	-	-	-	-	-	-	-
differing locking hierarchy	USH	-	-	-	-	-	-	-	-	-	-	-	-	-	-	-	-	-	-	-	-	-
free wheel cam	FREI	-	-	-	-	-	-	-	-	-	-	-	-	-	-	-	-	-	-	-	-	-
free wheel cam for geared lock	FZG	-	-	-	-	-	-	-	-	-	-	-	-	-	-	-	-	-	-	-	-	-
four-eyes principle	DUP	-	-	-	-	-	-	-	-	-	-	-	-	-	-	-	-	-	-	-	-	-

## HZ Half Cylinder



### Ordering information

- HZ cylinder length A, [finish], [security and usage options]

### Applications and usage

- For single-turn or multi-turn mortise locks and other locks with a profile cylinder hole
- Key switch
- Activating devices
- Garage doors and roller shutters fastened at the side

### Functional characteristics

- Can be operated with a key on one side
- Cam rotation: 360 degrees
- Cam removal position: 45 degrees
- Cam can be set to 8 positions (45°, 90°, 135°, 180°, 225°, 270°, 315°, 360°)

### Security features

- Hard metal drilling protection in plug and body
- Pulling protection through chrome-nickel connecting rod

### Technical data

- Cylinder body base material: brass
- Cylinder plug base material: nickel silver
- All scanning elements coated with Triflon
- Cam home position: 45 degrees (changeable)
- Cam width: 9.3 mm
- Modular cylinder design

### Scope of supply

Half cylinder with fixing screw

### Installation & operation

- Easy cylinder installation in a prepared, empty cylinder hole
- Cylinder should be flush with the escutcheon or rose
- Cylinder fixed through a M5 fastening hole

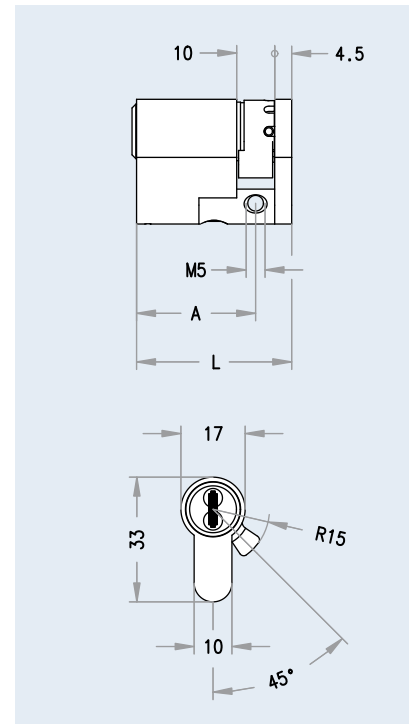

### Cylinder lengths

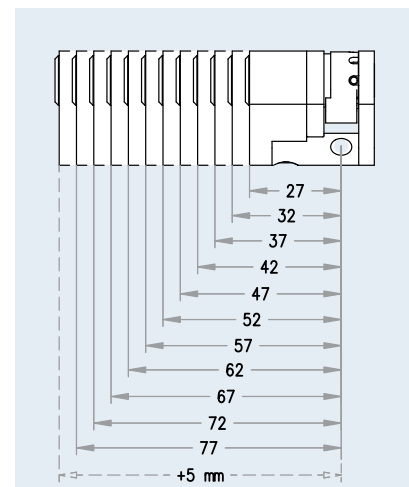

### Finishes

Finishes	Abbreviations	Standard	Surcharge
Polished brass	PB	●	
Satin nickel	NI	●	
Polished nickel	PN		○
Satin chrome	CR		○
Polished chrome	PC		○
Black	BL		○
Brown	BW		○
Satin brass	BR		○
PVD	PVD		○

## HZ/S Half Cylinder



### Ordering information

- ▶ HZ/S cylinder length A, [finish], [security and usage options]

### Applications and usage

- ▶ Key switch
- ▶ Activating devices
- ▶ Garage doors, roller shutters, lifts, escalators where fastening is from rear

### Functional characteristics

- ▶ Can be operated with a key on one side
- ▶ Cam rotation: 360 degrees
- ▶ Cam removal position: 30 degrees
- ▶ Cam can be set to 8 positions (45°, 90°, 135°, 180°, 225°, 270°, 315°, 360°)
- ▶ Fastened through two M4 threaded holes at the rear
- ▶ Fastened through one M5 threaded hole at the side

### Security features

- ▶ Hard metal drilling protection in plug and body
- ▶ Pulling protection through chrome-nickel connecting rod

### Technical data

- ▶ Cylinder body base material: brass
- ▶ Cylinder plug base material: nickel silver
- ▶ All scanning elements coated with Triflon
- ▶ Cam home position: 45 degrees (changeable)
- ▶ Cam width: 9.3 mm
- ▶ Modular cylinder design

### Scope of supply

Half cylinder with fixing screw

### Installation & operation

- ▶ Easy cylinder installation in a prepared, empty cylinder hole
- ▶ Cylinder should be flush with the escutcheon or rose
- ▶ Cylinder fixed through a M5 fastening hole (at the side)
- ▶ Cylinder fixed through two rear M4 fastening holes

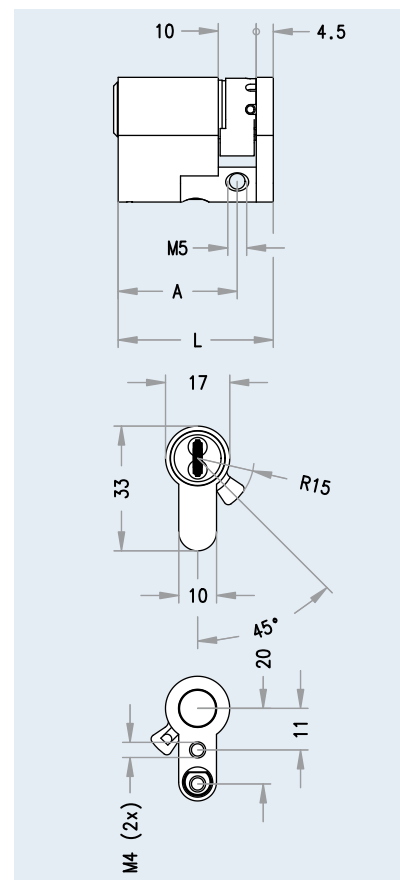

### Cylinder lengths

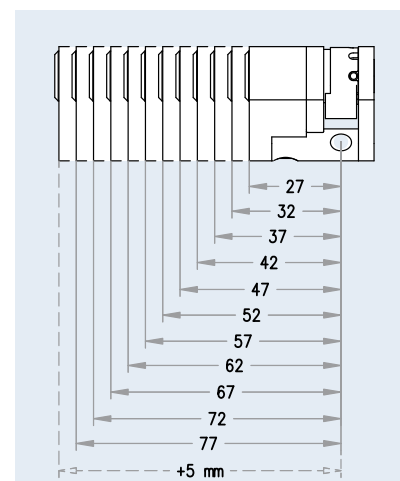

### Finishes

Finishes	Abbreviations	Standard	Surcharge
Polished brass	PB	●	
Satin nickel	NI	●	
Polished nickel	PN		○
Satin chrome	CR		○
Polished chrome	PC		○
Black	BL		○
Brown	BW		○
Satin brass	BR		○
PVD	PVD		○

## RDZ Round Double Cylinder



### Ordering information

- RDZ cylinder length A/B [finish] [security and usage options]

### Applications and usage

- For mortise locks designed for round profile cylinders (Swiss profile)
- For house doors, connecting doors, flat entry doors, security doors, metal frame doors, ...

### Functional characteristics

- Lockable on both sides with key
- Cam rotation: 360 degrees
- Cam removal position: 22.5 degrees (from the short side)

### Security features

- Hard metal drilling protection in plug
- Vertical key insertion for optimal scanning of locking elements

### Technical data

- Cylinder body base material: brass
- Cylinder plug base material: nickel silver
- All scanning elements coated with Triflon
- Cam home position: 22.5 degrees
- Cam width: 9.3 mm
- Compact design

### Scope of supply

Locking cylinder with fixing screw

### Installation & operation

- Easy cylinder installation in a prepared, empty cylinder hole
- Cylinder projecting length may not exceed 3 mm for security-relevant doors
- Cylinder fixed through a M5 fastening hole

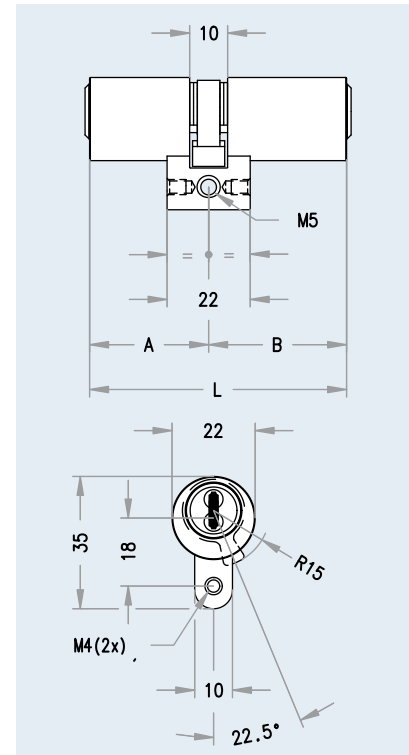

### Cylinder lengths

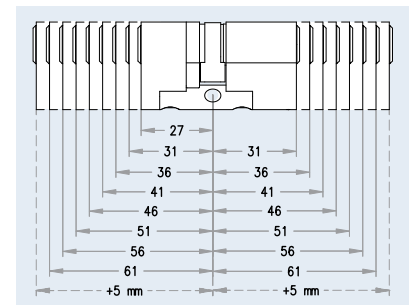

### Finishes

Finishes	Abbreviations	Standard	Surcharge
Polished brass	PB	●	
Satin nickel	NI	●	
Polished nickel	PN		○
Satin chrome	CR		○
Polished chrome	PC		○
Black	BL		○
Brown	BW		○
Satin brass	BR		○
PVD	PVD		○

## RKZ Round Thumbturn Cylinder



### Ordering information

RKZ cylinder length A/B (A=outer side; B=inner side (thumbturn), [finish], [security and usage options] When thumbturn design is not specified: AKN standard thumbturn

### Applications and usage

- ▶ For mortise locks designed for round profile cylinders (Swiss profile)
- ▶ For house doors, connecting doors, flat entry doors, security doors, metal frame doors, ...

### Functional characteristics

- ▶ Can be locked from the outside with a key
- ▶ Thumbturn on the inside to lock and unlock the door
- ▶ Cam rotation: 360 degrees

### Security features

- ▶ Hard metal drilling protection in the outside plug and body
- ▶ Vertical key insertion for optimal scanning of locking elements

### Technical data

- ▶ Cylinder body base material: brass
- ▶ Cylinder plug base material: nickel silver
- ▶ All scanning elements coated with Triflon
- ▶ Cam home position: 22.5 degrees
- ▶ Cam width: 9.3 mm
- ▶ Compact cylinder design

### Scope of supply

- ▶ Locking cylinder with thumbturn and fixing screw

### Installation & operation

- ▶ Easy cylinder installation in a prepared, empty cylinder hole
- ▶ Cylinder projecting length may not exceed 3 mm for security-relevant doors
- ▶ If required, inside thumbturn can be removed with a tool and replaced with another EVVA thumbturn
- ▶ Cylinder fixed through a M5 fastening hole

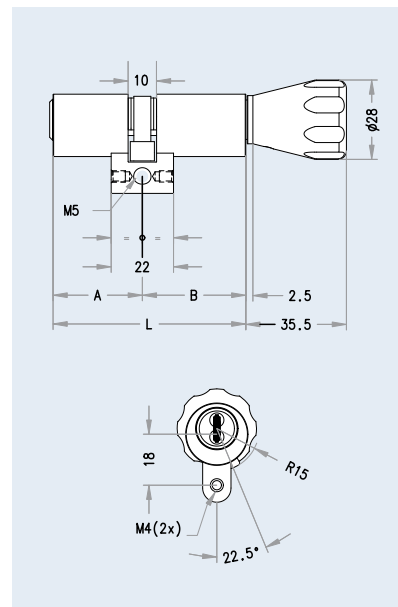

### Cylinder lengths

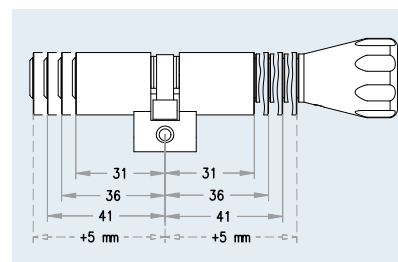

### Finishes

Finishes	Abbreviations	Cylinder	AKN, KKN, FKN	RKN, MKN	OKN, OKNA	GKN
Polished brass	PB	●	●	●	●	●
Satin nickel	NI	●	●	●	●	●
Polished nickel	PN	○	○	○	○	○
Satin chrome	CR	○	○	○	○	○
Polished chrome	PC	○	○	○	○	○
Black	BL	○	○	○	○	○
Brown	BW	○	○	○	○	○
Satin brass	BR	○	○	○	○	○
PVD	PVD	○	○	○	○	○
RAL colour	RAL	○	○	○	○	○

## RHZ Round Half Cylinder



### Ordering information

- RHZ cylinder length A  
[finish] [security and usage options]

### Applications and usage

- For single-turn or multi- turn mortise locks designed for round profile cylinders (Swiss profile)
- Key switches designed for round profile cylinders
- Activating devices
- Garage doors, roller shutters

### Functional characteristics

- Can be operated with a key on one side
- Cam rotation: 360 degrees
- Cam removal position: 45 degrees
- Cam can be set to 8 positions (45°, 90°, 135°, 180°, 225°, 270°, 315°, 360°)

### Security features

- Hard metal drilling protection in plug

### Technical data

- Cylinder body base material: brass
- Cylinder plug base material: nickel silver
- All scanning elements coated with Triflon
- Cam home position: 45 degrees (changeable)
- Cam width: 9.3 mm
- Compact cylinder design

### Scope of supply

- Round half cylinder with fixing screw

### Installation & operation

- Easy cylinder installation in a prepared, empty cylinder hole
- Cylinder should be flush with the escutcheon or rose
- Cylinder fixed through a M5 fastening hole

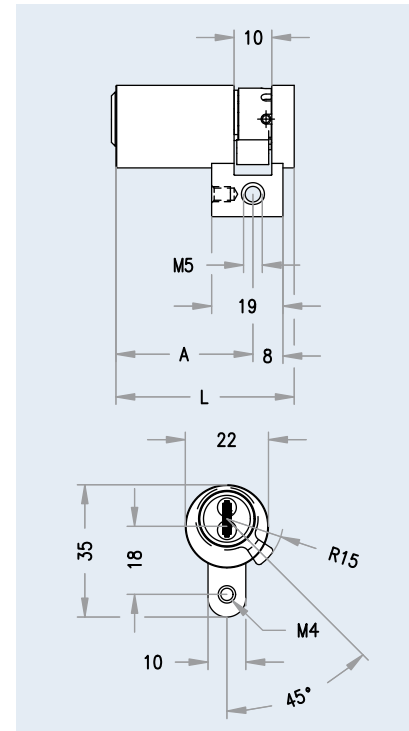

### Cylinder lengths

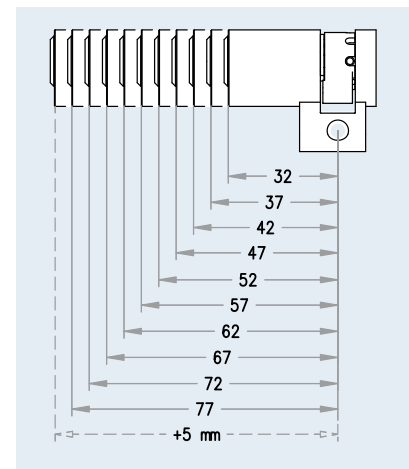

### Finishes

Finishes	Abbreviations	Standard	Surcharge
Polished brass	PB	●	
Satin nickel	NI	●	
Polished nickel	PN		○
Satin chrome	CR		○
Polished chrome	PC		○
Black	BL		○
Brown	BW		○
Satin brass	BR		○
PVD	PVD		○

## HPM Padlock



### Ordering information

- ▶ HPM (standard: hardened steel shackle)

### Applications and usage

- ▶ Elements and containers secured with a hasp
- ▶ Roller shutters
- ▶ Barrier systems
- ▶ Chain barriers
- ▶ Security fences

### Functional characteristics

- ▶ Secures elementary fastening devices
- ▶ Padlock with round security shackle
- ▶ Operated on lower surface
- ▶ Locking rotation: 90 degrees
- ▶ Key can only be removed when locked

### Security features

- ▶ Hard metal drilling protection in plug and body
- ▶ Positively driven locking of the security shackle

### Technical data

- ▶ Padlock base material: brass, satin nickel plated
- ▶ Shackle made of hardened, chemically nickel plated steel or stainless steel
- ▶ Shackle diameter: 8 mm
- ▶ Standard shackle: clearance height: 30 mm  
clearance width: 25 mm

### Installation & operation

- ▶ Can be used with any hasp with an opening > 8 mm

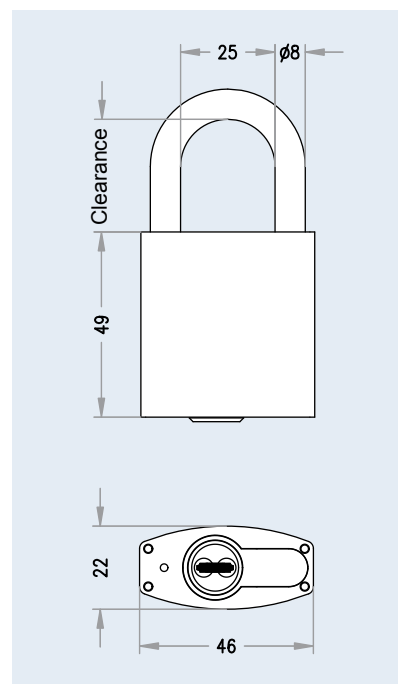



## HPM BS Padlock



### Ordering information

- ▶ HPM BS (standard: hardened steel shackle)

### Applications and usage

- ▶ Elements and containers secured with a hasp
- ▶ Roller shutters
- ▶ Barrier systems
- ▶ Chain barriers
- ▶ Security fences

### Functional characteristics

- ▶ Secures elementary fastening devices
- ▶ Padlock with round security shackle
- ▶ Operated on lower surface
- ▶ Locking rotation: 90 degrees
- ▶ Key can only be removed when locked

### Security features

- ▶ Hard metal drilling protection in plug and body
- ▶ Positively driven locking of the security shackle
- ▶ Hardened steel shackle protection

### Technical data

- ▶ Padlock base material: brass, satin nickel plated
- ▶ Shackle made of hardened, chemically nickel-plated steel
- ▶ Shackle diameter: 8 mm
- ▶ Standard shackle: clearance height: 15 mm  
clearance width: 12 mm

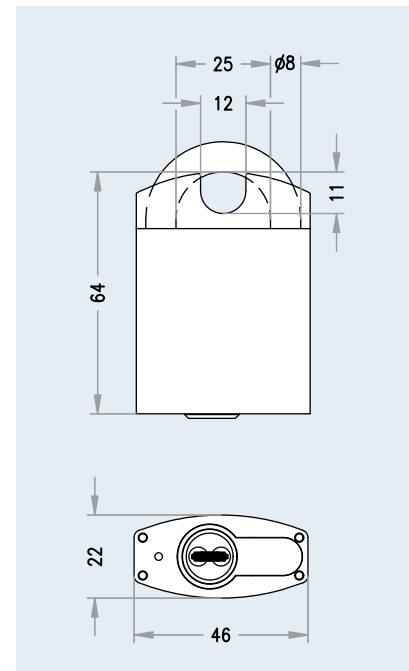

### Installation & operation

- ▶ Can be used with any hasp with an opening > 8 mm

## HPM SSW Padlock With Dust Cover



### Ordering information

- ▶ HPM SSW (standard: hardened steel shackle),
- ▶ shackle made of stainless steel on request

### Applications and usage

- ▶ Elements and containers secured with a hasp
- ▶ Roller shutters
- ▶ Barrier systems
- ▶ Chain barriers
- ▶ Security fences

### Functional characteristics

- ▶ Operated on lower surface
- ▶ Locking rotation: 90 degrees
- ▶ Key can only be removed when locked
- ▶ With dust cover

### Security features

- ▶ Hard metal drilling protection in plug and body
- ▶ Positively driven locking of the security shackle

### Technical data

- ▶ Padlock base material: brass, satin nickel plated
- ▶ Shackle made of hardened, chemically nickel plated steel or stainless steel
- ▶ Shackle diameter: 8 mm
- ▶ Standard shackle: clearance height: 30 mm  
clearance width: 25 mm
- ▶ Dust cover

### Installation & operation

- ▶ Can be used with any hasp with an opening > 8 mm

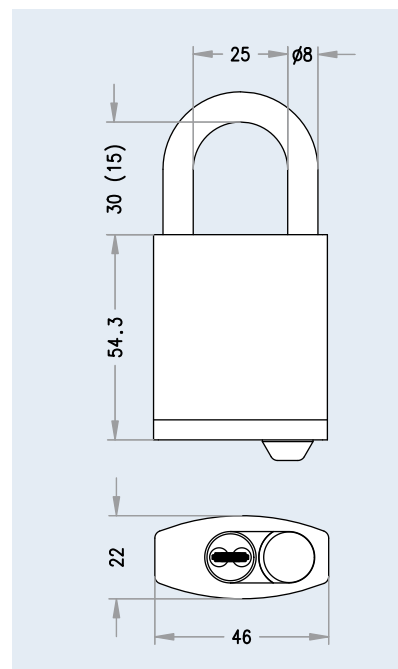

## HPM Padlock With Extra Long Shackle



### Ordering information

- ▶ HPM shackle LH xx (shackle in LH design always made of stainless steel)  
LH = clearance

### Applications and usage

- ▶ Roller shutters
- ▶ Chain barriers
- ▶ Security fences

### Functional characteristics

- ▶ Secures elementary fastening devices
- ▶ Padlock with round security shackle
- ▶ Operated on lower surface
- ▶ Locking rotation: 90 degrees
- ▶ Key can only be removed when locked

### Security features

- ▶ Hard metal drilling protection in plug and body
- ▶ Positively driven locking of the security shackle

### Technical data

- ▶ Padlock base material: brass, satin nickel plated
- ▶ Shackle made of hardened, chemically nickel plated steel or stainless steel
- ▶ Shackle diameter: 8 mm

### Installation & operation

- ▶ Can be used with any hasp with an opening > 8 mm

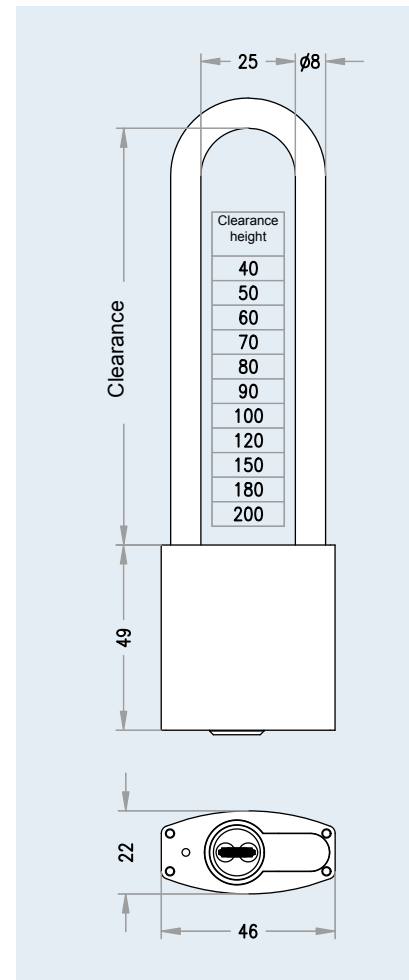



## MB19 Cam Lock



### Ordering information

MB19 [finish], [cam], if the standard cam is used, no further information is necessary

### Applications and usage

- ▶ Wooden and sheet metal boxes
- ▶ Mailboxes with small cylinder hole
- ▶ Showcase locks

### Functional characteristics

- ▶ Locking by cam
- ▶ Locking rotation: 90 degrees
- ▶ Key can only be removed in closed position
- ▶ Flat side finishes prevent rotation
- ▶ Cylinder fixed at rear with a hex nut (WS22)
- ▶ Standard cam: 33.5 mm

### Technical data

- ▶ Cylinder front face Ø 22 mm
- ▶ M19 threads for WS22 fastening nut
- ▶ Base material: brass
- ▶ Steel cam, blue galvanised

### Scope of supply

- ▶ Locking cylinder with standard cam 5072, 33.5 mm
- ▶ M19 fastening nut

### Installation & operation

- ▶ For material thicknesses up to 14 mm
- ▶ Cylinder hole Ø 19, flattened to 16 mm
- ▶ Cam secured by 2 rear screws

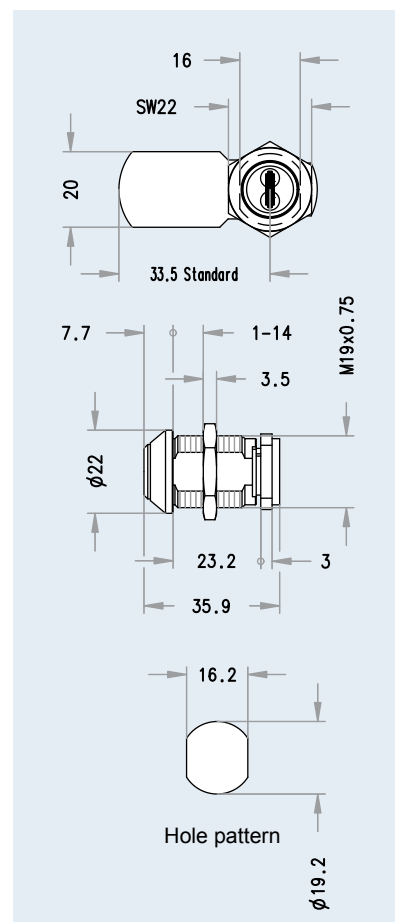

## MB19SZ Switch Cylinder



### Ordering information

MB19SZ [finish]

#### Applications and usage

- ▶ As switch cylinder with integrated switch element
- ▶ For direct activation of circuits

#### Functional characteristics

- ▶ Locking rotation: 90 degrees
- ▶ On/off switch function
- ▶ Key can only be removed in one position

#### Technical data

- ▶ Cylinder front face Ø 22 mm
- ▶ M19 threads for WS22 fastening nut
- ▶ Base material: brass
- ▶ F4 T7 switch element

#### Scope of supply

- ▶ Locking cylinder with switch elements and connecting cable
- ▶ M19 fastening nut

#### Installation & operation

- ▶ For material thicknesses up to 14 mm
- ▶ Cylinder hole Ø 19, flattened to 16 mm
- ▶ Electrical connection must be performed by a professional

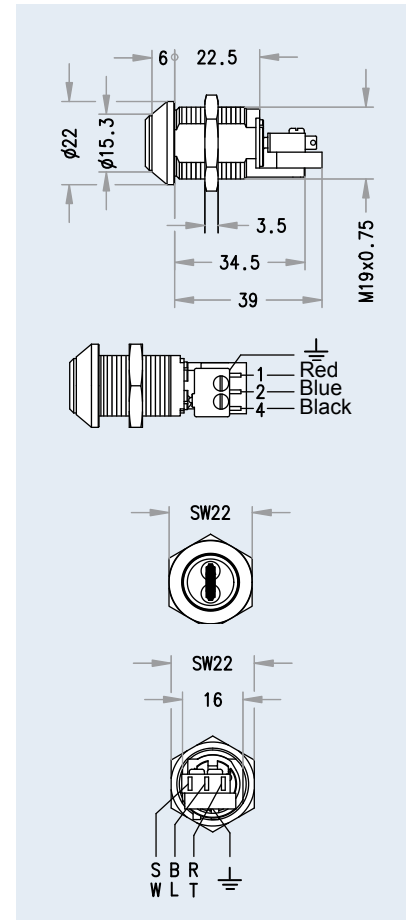

## MB23 Cam Lock



### Ordering information

MB23 [finish], [cam], if the standard cam is used, no further information is necessary

### Applications and usage

- ▶ Wooden and sheet metal boxes
- ▶ Mailboxes with medium cylinder hole
- ▶ Showcase locks
- ▶ Emergency key boxes
- ▶ Key cabinets
- ▶ Wardrobes/lockers
- ▶ Cabinets

### Functional characteristics

- ▶ Locking by cam
- ▶ Locking rotation: 90 degrees
- ▶ Key can only be removed in closed position
- ▶ Flat side finishes prevent rotation
- ▶ Cylinder fixed at rear with a hex nut (WS27)
- ▶ Standard cam: 33.5 mm
- ▶ S function (MB23S): key can be removed in either of 2 positions

### Security features

- ▶ Hard metal elements to prevent drilling into plug
- ▶ Flat finishes on both cylinder sides prevent rotation

### Technical data

- ▶ Cylinder front face  $\varnothing$  24.8 mm
- ▶ M22 threads for WS27 fastening nut
- ▶ Base material: brass
- ▶ Steel cam, blue galvanised

### Scope of supply

- ▶ Locking cylinder with standard cam 5072, 33.5 mm
- ▶ M22 fastening nut

### Installation & operation

- ▶ For material thicknesses up to 17 mm
- ▶ Cylinder hole  $\varnothing$  23, flattened to 17.7 mm
- ▶ Cam secured by 2 rear screws

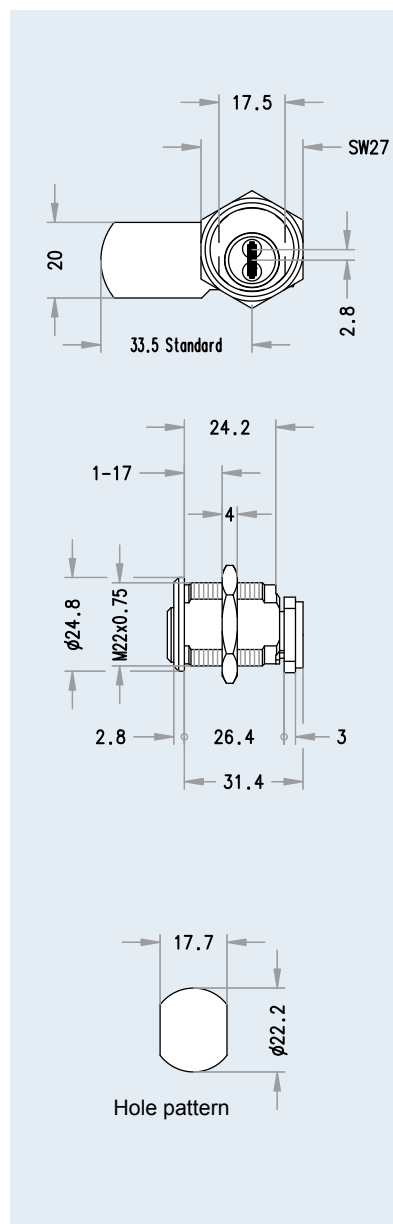

## MB23SZ Switch Cylinder



### Ordering information

MB23SZ [finish]

#### Applications and usage

- ▶ As switch cylinder with integrated switch element
- ▶ For direct activation of circuits

#### Scope of supply

- ▶ Locking cylinder with switch elements and connecting cable
- ▶ WS27 fastening nut

#### Functional characteristics

- ▶ Locking rotation: 90 degrees
- ▶ On/off switch function
- ▶ Key can only be removed in one position

#### Technical data

- ▶ Cylinder front face  $\varnothing$  24.8 mm
- ▶ M23 threads for WS27 fastening nut
- ▶ Base material: brass
- ▶ F4 T7 switch element
- ▶ With earth connection

#### Installation & operation

- ▶ For material thicknesses up to 14 mm
- ▶ Cylinder hole  $\varnothing$  23, flattened on one side to 17.7 mm
- ▶ Electrical connection must be performed by a professional

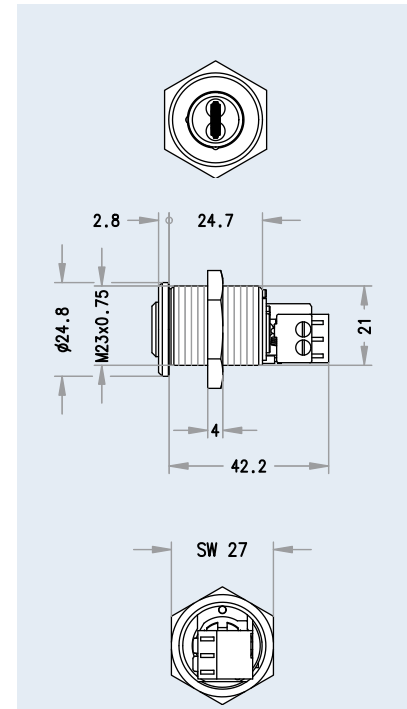



## MB23GT Cam Lock For Glass Doors



### Ordering information

MB23 [finish], [cam], [fastening plate], if the standard cam is used, no further information is necessary

### Applications and usage

- ▶ Glass showcase locks
- ▶ Glass door cupboards

### Functional characteristics

- ▶ Locking by cam
- ▶ Locking rotation: 90 degrees
- ▶ Key can only be removed in closed position
- ▶ Flat side finishes prevent rotation
- ▶ Cylinder fixed at rear with a hex nut (WS27)
- ▶ Standard cam: 33.5 mm
- ▶ Bevelled fastening plate

### Security features

- ▶ Hard metal elements to prevent drilling into plug
- ▶ Flat finishes on both cylinder sides prevent rotation

### Technical data

- ▶ Cylinder front face  $\varnothing$  24.8 mm
- ▶ M22 threads for WS27 fastening nut
- ▶ Base material: brass
- ▶ Steel cam, blue galvanised
- ▶ Brushed aluminium fastening plate

### Scope of supply

- ▶ Locking cylinder with standard cam 5072, 33.5 mm
- ▶ M22 fastening nut
- ▶ Fastening plate
- ▶ Plastic disc

### Installation & operation

- ▶ For material thicknesses up to 17 mm
- ▶ Cylinder hole  $\varnothing$  23, flattened to 17.7 mm
- ▶ Cam secured by 2 rear screws
- ▶ Plastic disc to protect glass

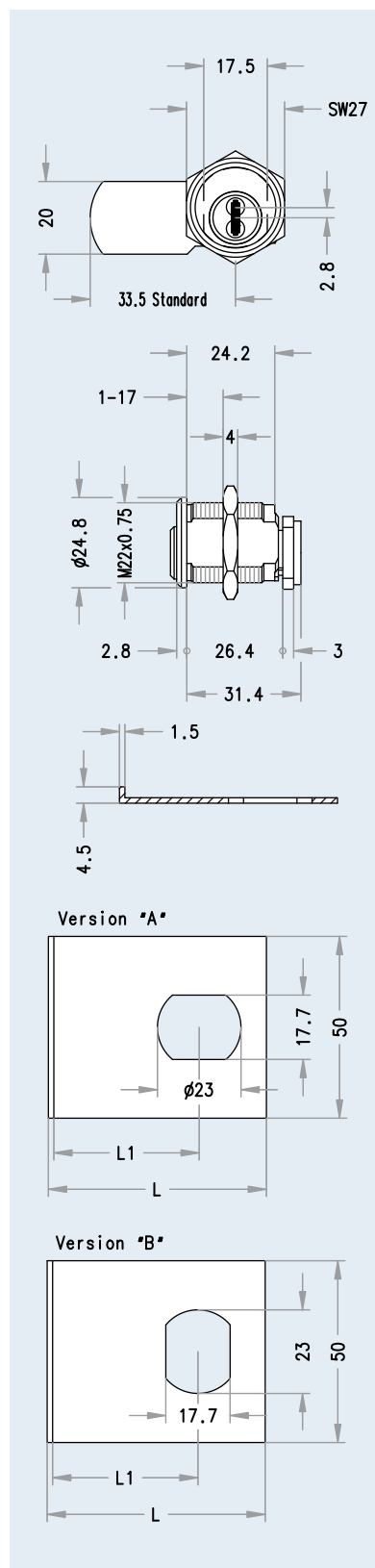

## MB23 MB Cam Lock



### Ordering information

MB23MB [finish], [cam], if the standard cam is used, no further information is necessary

### Applications and usage

- ▶ Wooden and sheet metal boxes
- ▶ Mailboxes with medium cylinder hole
- ▶ Showcase locks
- ▶ Emergency key boxes
- ▶ Key cabinets
- ▶ Wardrobes/lockers
- ▶ Cabinets
- ▶ Rose for metal thicknesses < 0.5 mm

### Functional characteristics

- ▶ Locking by cam
- ▶ Locking rotation: 90 degrees
- ▶ Key can only be removed in closed position
- ▶ Flat side finishes to prevent rotation
- ▶ Cylinder fixed at rear with a hex nut (WS27)
- ▶ Standard cam: 33.5 mm

### Technical data

- ▶ Cylinder front face  $\varnothing$  24.8 mm
- ▶ M22 threads for WS27 fastening nut
- ▶ Base material: brass
- ▶ Steel cam, blue galvanised

### Scope of supply

- ▶ Locking cylinder with standard cam 5072, 33.5 mm
- ▶ M22 fastening nut

### Installation & operation

- ▶ For material thicknesses up to 17 mm
- ▶ Cylinder hole  $\varnothing$  23, flattened on one side to 21 mm
- ▶ Cam secured by 2 rear screws

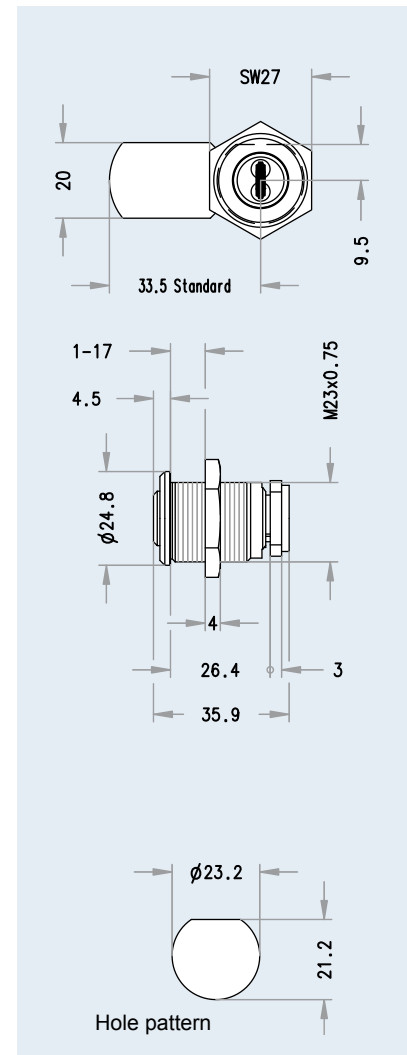



## MB30 Cam Lock



### Ordering information

MB30 [finish], [cam], if the standard cam is used, no further information is necessary

### Applications and usage

- ▶ Wooden and sheet metal boxes
- ▶ Showcase locks
- ▶ Emergency key boxes with interlocking device
- ▶ Key safes
- ▶ Key cabinets
- ▶ Wardrobes/lockers
- ▶ Cabinets
- ▶ Fuse and junction boxes

### Functional characteristics

- ▶ Locking by cam
- ▶ Locking rotation: 90 degrees
- ▶ Key can only be removed in closed position
- ▶ Flat side finishes prevent rotation
- ▶ Cylinder fixed at rear with a hex nut (WS36), standard cam: 33.5 mm
- ▶ S function (MB30S): key can be removed in either of 2 positions

### Technical data

- ▶ Cylinder front face  $\varnothing$  30 mm
- ▶ M30 threads for WS36 fastening nut
- ▶ Base material: brass
- ▶ Steel cam, blue galvanised

### Scope of supply

- ▶ Locking cylinder with standard cam 5072, 33.5 mm
- ▶ M30 fastening nut

### Installation & operation

- ▶ For material thicknesses between 1 and 20 mm
- ▶ Cylinder hole  $\varnothing$  30, flattened to 22 mm
- ▶ Cam secured by 2 rear screws

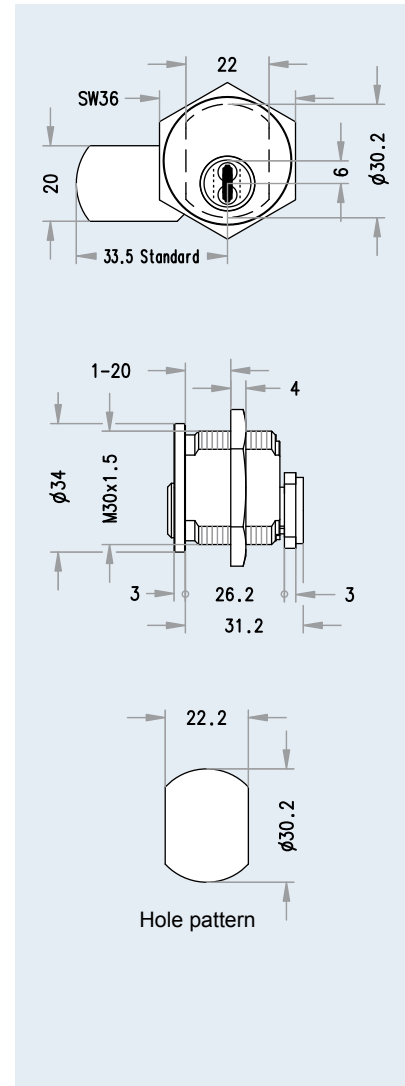

## MB30SZ Switch Cylinder



### Ordering information

MB30SZ [finish]

#### Applications and usage

- ▶ As switch cylinder with integrated switch element
- ▶ For direct activation of circuits

#### Scope of supply

- ▶ Locking cylinder with switch elements and connecting cable
- ▶ WS36 fastening nut

#### Functional characteristics

- ▶ Locking rotation: 90 degrees
- ▶ On/off switch function
- ▶ Key can only be removed in one position

#### Technical data

- ▶ Cylinder front face Ø 34 mm
- ▶ M30 threads for WS36 fastening nut
- ▶ Base material: brass
- ▶ F4 T7 switch element
- ▶ With earth connection

#### Installation & operation

- ▶ For material thicknesses up to 20 mm
- ▶ Cylinder hole Ø 30, flattened on one side to 22 mm
- ▶ Electrical connection must be performed by a professional

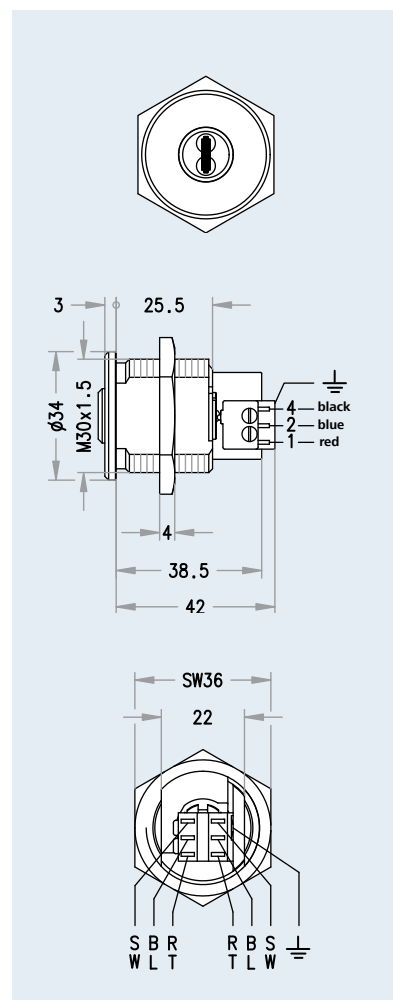

## MB30 MB Cam Lock



### Ordering information

MB30MB [finish], [cam], if the standard cam is used, no further information is necessary

### Applications and usage

- ▶ Wooden and sheet metal boxes
- ▶ Showcase locks
- ▶ Emergency key boxes with interlocking device
- ▶ Key safes
- ▶ Key cabinets
- ▶ Wardrobes/lockers
- ▶ Cabinets
- ▶ Fuse and junction boxes

### Functional characteristics

- ▶ Locking by cam
- ▶ Locking rotation: 90 degrees
- ▶ Key can only be removed in closed position
- ▶ Flat side finishes prevent rotation
- ▶ Cylinder fixed at rear with a hex nut (WS36)
- ▶ Standard cam: 33.5 mm

### Scope of supply

- ▶ Locking cylinder with standard cam 5072, 33.5 mm
- ▶ M30 fastening nut

### Installation & operation

- ▶ For material thicknesses between 1 and 20 mm
- ▶ Cylinder hole  $\varnothing$  30, flattened to 22 mm
- ▶ Cam secured by 2 rear screws

### Technical data

- ▶ Cylinder front face  $\varnothing$  30 mm
- ▶ M30 threads for WS36 fastening nut
- ▶ Base material: brass
- ▶ Steel cam, blue galvanised

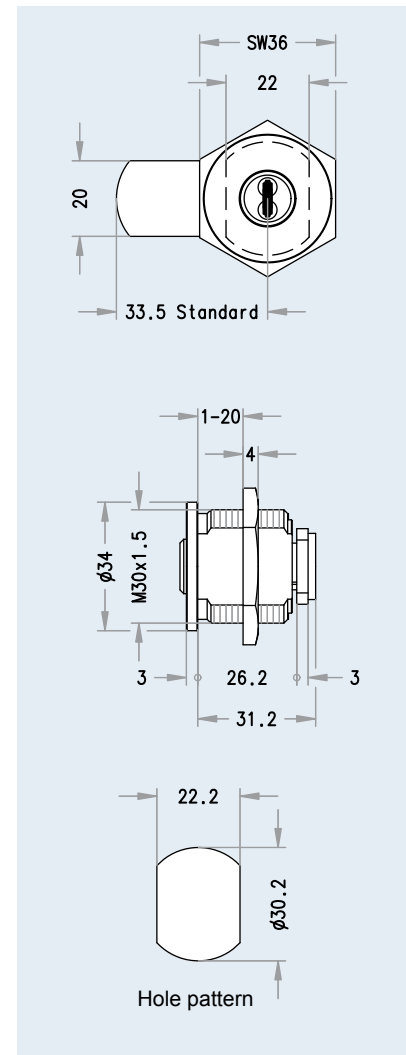

## MRH22 Bolt Lock

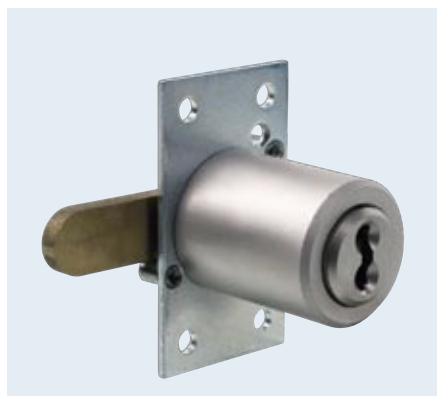

### Ordering information

MRH22 [S] [cylinder length], [finish],  
[mounting plate: rectangular (E), round (R)]

### Applications and usage

- ▶ Wooden furniture doors and drawers

### Functional characteristics

- ▶ Locking by cam
- ▶ Bolt rotation: 100 degrees
- ▶ Key can only be removed in closed position
- ▶ Cylinder fixed by rear mounting plate
- ▶ Standard cam: 31.5 mm

### Technical data

- ▶ Cylinder front face  $\varnothing$  22 mm without rose
- ▶ Base material: brass
- ▶ Brass cam and steel mounting plate, blue galvanised

### Scope of supply

- ▶ Bolt lock with 31.5 mm standard cam, mounting plate, without rose

### Installation & operation

- ▶ For material thicknesses between 25 mm and 65 mm
- ▶ Fixed at rear by rectangular mounting plate (standard) or
- ▶ On request, with a round mounting plate
- ▶ Cylinder can be used right/left
- ▶ Design S: key can be removed in 2 positions

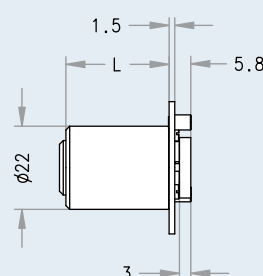
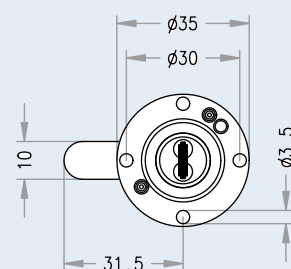
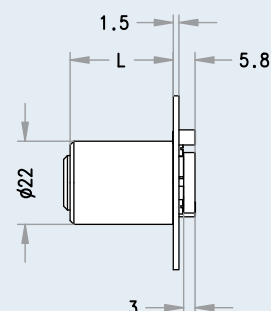
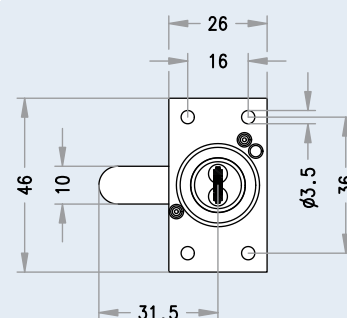

Size	L
0	27.3
1	32.3
2	37.3
3	42.3
4	47.3
5	57.3
6	67.3

## SRZ22 Bolt Lock

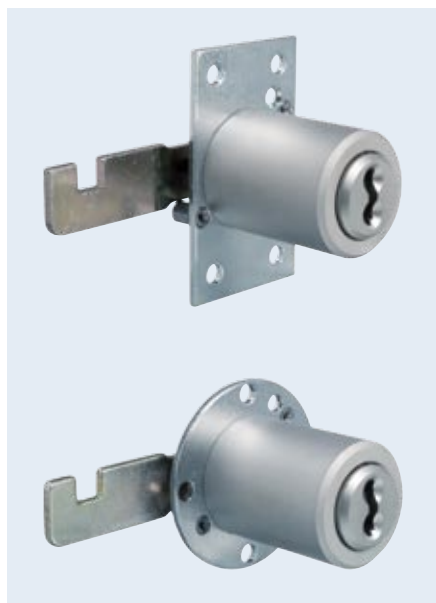

### Ordering information

SRZ22 [cylinder length], [finish], [mounting plate: rectangular (E), round (R)]

### Applications and usage

- For sliding doors in wooden or metal furniture

### Functional characteristics

- Locking by cam (pivot bolt)
- Bolt rotation: 90 degrees
- Locking rotation: 360 degrees
- Key can be removed in open and closed position
- Cylinder fixed by rear mounting plate
- Standard cam: 40 mm

### Scope of supply

- Bolt lock with 40 mm standard cam, mounting plate, without rose

### Installation & operation

- For material thicknesses between 25 mm and 65 mm
- Fixed at rear by rectangular mounting plate (standard) or
- On request, with a round mounting plate
- Cylinder can be used right/left

### Technical data

- Cylinder front face  $\varnothing$  22 mm without rose
- Base material: brass
- Steel cam and mounting plate, blue galvanised

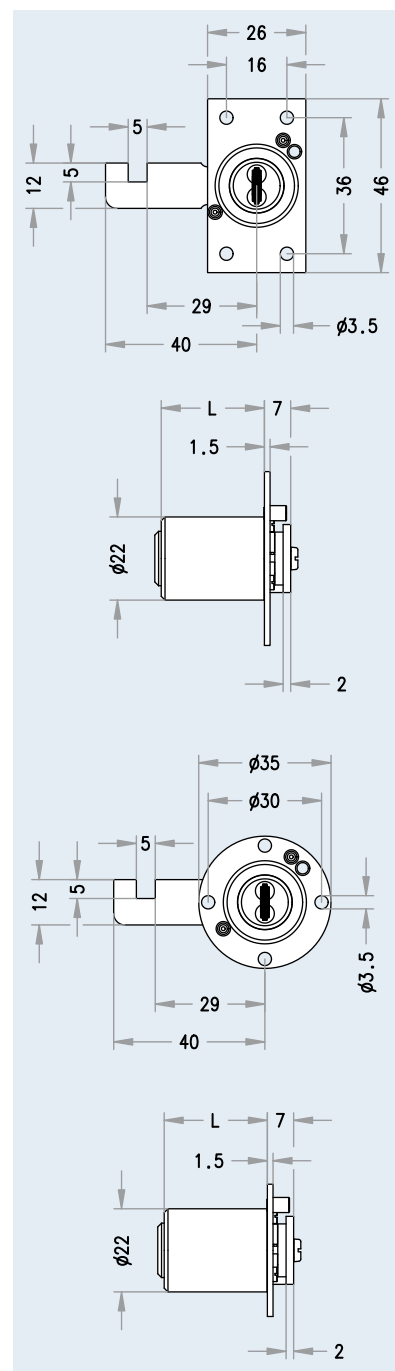



## ZB27 Cam Lock



### Ordering information

ZB27 [finish], [cam], if the standard cam is used, no further information is necessary

### Applications and usage

- ▶ Wooden and sheet metal boxes
- ▶ Mailboxes with large cylinder hole
- ▶ Mailbox systems with large cylinder hole
- ▶ Electric junction boxes
- ▶ Fuse boxes

### Functional characteristics

- ▶ Locking by cam
- ▶ Locking rotation: 90 degrees
- ▶ Key can only be removed in closed condition
- ▶ Cylinder fixed by rear clamp plate
- ▶ Standard cam 5072, 33.5 mm

### Technical data

- ▶ Cylinder front face Ø 34 mm without rose, 50 mm with rose
- ▶ Base material: brass
- ▶ Steel cam, blue galvanised

### Scope of supply

- ▶ Locking cylinder with standard cam 5072, 33.5 mm, without rose

### Installation & operation

- ▶ For material thicknesses between 1 and 8.5 mm (without rose)
- ▶ Cam secured by 2 rear screws

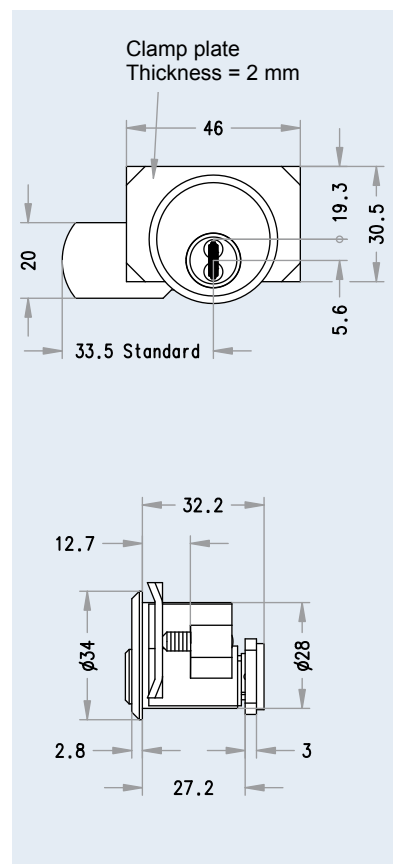

## ZB27K Cam Lock



### Ordering information

ZB27K [finish], [cam], if the standard cam is used, no further information is necessary

### Applications and usage

- ▶ Wooden and sheet metal boxes
- ▶ Electric junction boxes in outdoor areas
- ▶ Fuse boxes in outdoor areas

### Functional characteristics

- ▶ Locking by cam
- ▶ Locking rotation: 90 degrees
- ▶ Key can only be removed in closed condition
- ▶ Cylinder fixed by rear clamp plate
- ▶ Standard cam 5072, 33.5 mm
- ▶ With dust cover

### Technical data

- ▶ Cylinder front face Ø 34 mm without rose, 50 mm with rose
- ▶ Base material: brass
- ▶ Steel cam, blue galvanised

### Scope of supply

- ▶ Cam lock with 33.5 mm standard cam, dust cover, without rose

### Installation & operation

- ▶ For material thicknesses between 1 and 8.5 mm (without rose)
- ▶ Cam secured by 2 rear screws

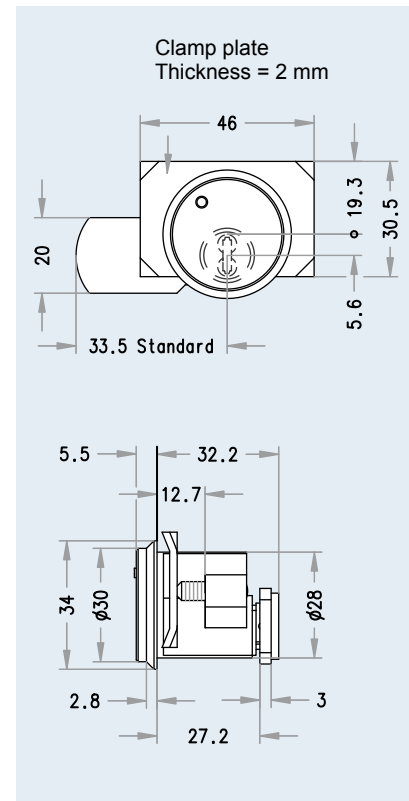

## HMB Euro Profile Cam Lock



### Ordering information

HMB, right/left specification necessary [finish], [cam], if the standard cam is used, no further information is necessary

### Applications and usage

- ▶ Wooden cupboards
- ▶ Showcase locks

### Functional characteristics

- ▶ Locking by cam
- ▶ Locking rotation: 90 degrees
- ▶ Key can only be removed in closed position
- ▶ Cylinder fixed by rear fastening plate with end-stop
- ▶ Standard cam 5072, 37.5 mm, heavy duty design

### Security features

- ▶ Hard metal elements to prevent drilling into plug

### Technical data

- ▶ Base material: brass
- ▶ Heavy-duty cam
- ▶ Steel cam and fastening plate, blue galvanised

### Scope of supply

- ▶ Standard cam 5072, 37.5 mm, heavy duty design
- ▶ With fastening plate

### Installation & operation

- ▶ For material thicknesses up to 28 mm
- ▶ Euro profile cylinder hole
- ▶ Cam secured by 2 rear screws
- ▶ Cylinder fixed by 4 screws

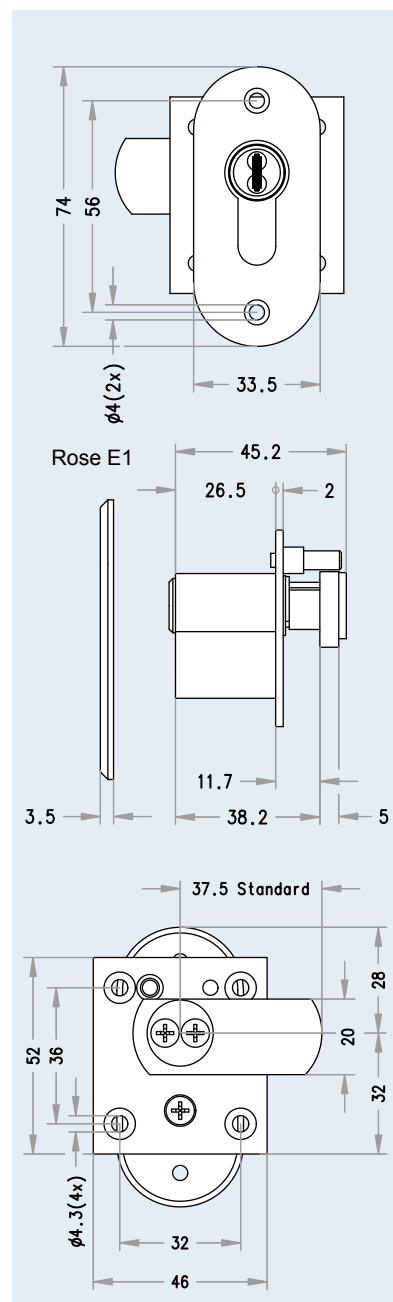

## MR22 Furniture Cylinder



### Ordering information

- MR22 [cylinder length], [finish]

### Applications and usage

- As furniture lock
- For cylinder turns
- As switch cylinder
- With one or more key removal positions (MR 22 S = 2 removal positions)

### Functional characteristics

- Locking rotation: 360 degrees

### Scope of supply

- Round furniture cylinder

### Installation & operation

- Cylinder can be used right/left
- Cylinder front face Ø 22 mm without rose
- Base material: brass

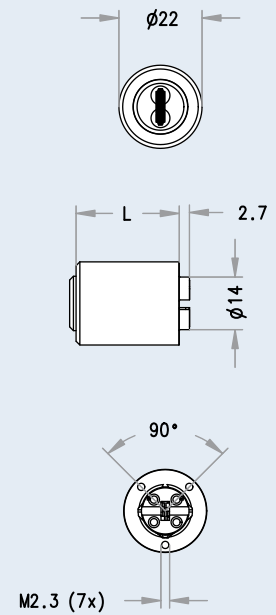

Size	L
0	27,3
1	32,3
2	37,3
3	42,3
4	47,3
5	57,3
6	67,3

## MR24 ASS Furniture Cylinder



### Ordering information

MR24 ASS [finish]

### Applications and usage

- ▶ Screw-on cylinder designed for Junie ASS system locks

### Functional characteristics

- ▶ Screw-on furniture cylinder for ASS system locks

### Technical data

- ▶ Cylinder front face Ø 24 mm without rose
- ▶ Base material: brass
- ▶ With adapter for ASS system locks

### Scope of supply

- ▶ MR24 round furniture cylinder without rose, with adapter and cam for ASS

### Installation & operation

- ▶ Simple installation by rear fixing to ASS lock cases

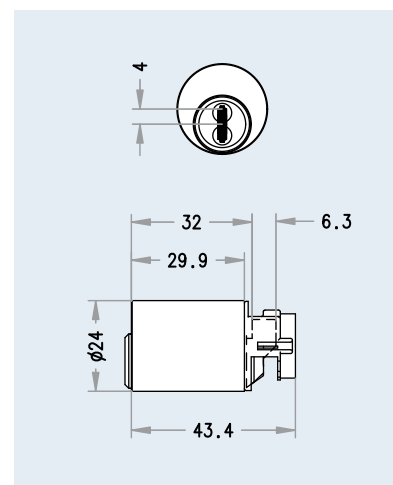

## MRT25 / MRL25 Furniture Cylinder



### Ordering information

MRT25/31, [finish], [lock case type]

MRT25/36, [finish], [lock case type]

MRL25/31, [finish]

MRL25/36, [finish]

### Applications and usage

- ▶ With Universal 4000 screw-on bolt lock for single locking
- ▶ For cupboard doors
- ▶ For cabinet doors
- ▶ With Universal 4540 espagnolette lock for multiple locking
- ▶ For cupboard doors with wide height clearance
- ▶ For cabinet doors with wide height clearance

### Functional characteristics

- ▶ Locking rotation: 360 degrees
- ▶ Rear fixing screws for attachment to Universal 4000 screw-on bolt lock (configured for door design)
- ▶ ZVS Universal 4000 screw-on central lock
- ▶ Universal 4540 espagnolette lock

### Technical data

- ▶ Cylinder front face  $\varnothing$  25 mm without rose
- ▶ Standard cylinder length: 31 mm
- ▶ Base material: brass

### Scope of supply

- ▶ MRT25 round furniture cylinder with rose, designed for Universal 4000 lock cases (door design), Universal 4540

### Installation & operation

- ▶ Universal clamp fixation to lock cases
- ▶ Easily retrofitted to lock cases

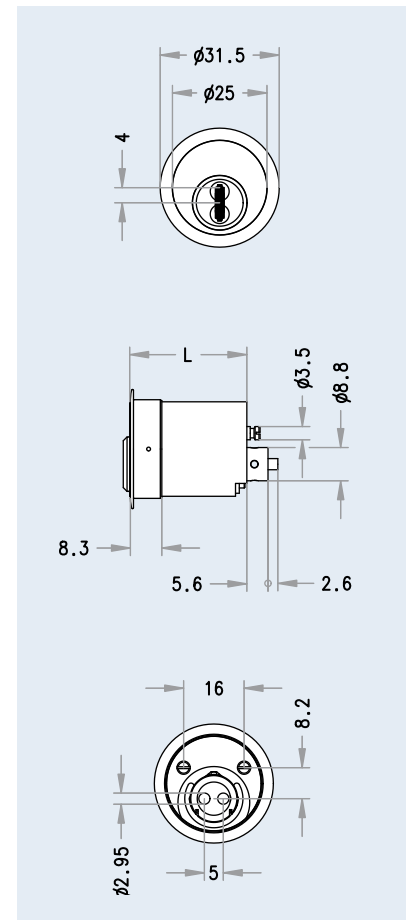

## ZVZ22 Central Lock Cylinder



### Ordering information

ZVZ22 [cylinder length], [finish]

### Applications and usage

- ▶ To lock drawers  
(12 mm stroke)

### Functional characteristics

- ▶ Bolt rotation: 180 degrees
- ▶ Locking rotation: 360 degrees
- ▶ Key can be removed in open and closed position
- ▶ Cylinder fixed by rear mounting plate

### Technical data

- ▶ Cylinder front face Ø 22 mm without rose
- ▶ Base material: brass

### Scope of supply

- ▶ Central lock cylinder with rose

### Installation & operation

- ▶ For material thicknesses between 25 mm and 65 mm
- ▶ Fixed at rear with rectangular mounting plate (standard) or
- ▶ On request, with a round mounting plate
- ▶ Cylinder can be used right/left

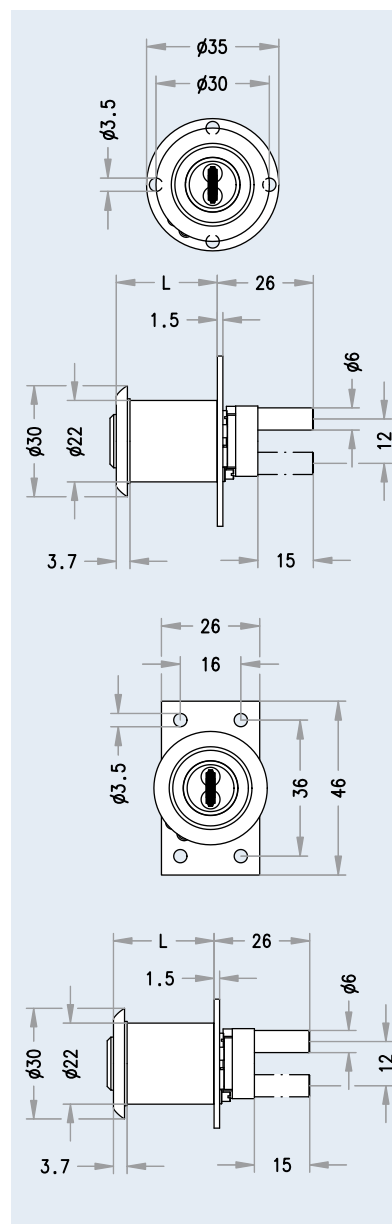

## DRZ22 Push-in Cylinder



### Ordering information

DRZ22, [finish]

#### Applications and usage

- ▶ To lock sliding doors

#### Functional characteristics

- ▶ Bolt stroke: 12 mm
- ▶ Locked without key
- ▶ Unlocked with key
- ▶ Cylinder fixed with integrated mounting plate

#### Technical data

- ▶ Cylinder front face  $\varnothing$  22 mm without rose
- ▶ Cylinder length: 28.5 mm
- ▶ Base material: brass

#### Scope of supply

- ▶ Push-in cylinder with rose

#### Installation & operation

- ▶ Fixed at rear, integrated mounting plate

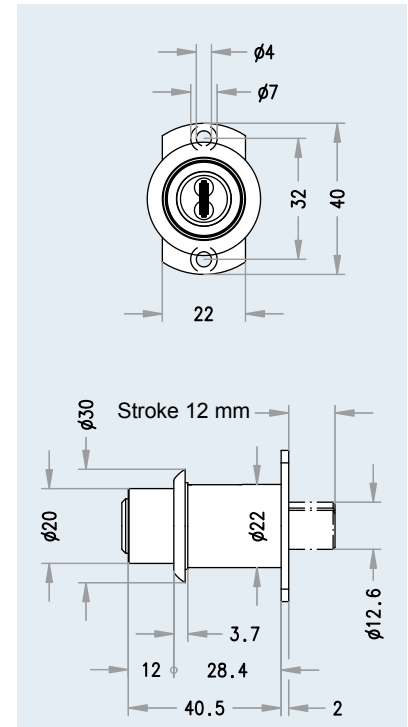



coin-operated lock [left/right] for [coins €  
1/ € 2/tokens]

- 
- Technical drawing of the R30.5 lock assembly, showing front and side views with dimensions in millimeters.
- Front View Dimensions:**
- Overall width: 110
  - Overall height: 170
  - Distance from top edge to top of handle: 47.5
  - Distance from right edge to handle center: 21
  - Distance from bottom edge to bottom of handle: 25
  - Label: €1
- Side View Dimensions:**
- Overall width: 25
  - Distance from front face to handle center: 17.5
  - Distance from handle center to back face: X
  - Front face radius: R30.5
  - Bottom hole diameter:  $\phi 12$
  - Bottom hole depth: 12.5
  - Bottom hole diameter:  $\phi 6.5$

## Universal 4000 Screw-on Furniture Lock



### Ordering information

Universal 4000

#### ■ Applications and usage

Screw-on furniture lock for:

- ▶ Furniture doors
- ▶ Cabinet doors
- ▶ Shutters

#### ■ Functional characteristics

- ▶ Preset backset for doors: 25, 30 and 35 mm
- ▶ Preset backset for shutters: 20, 25 and 30 mm
- ▶ Can be used on both left and right on doors and shutters

#### ■ Scope of supply

- ▶ Universal 4000 lock case, without fastening material, without locking plate

#### ■ Installation & operation

- ▶ Universal clamp fastening attached onto the lock case with side screws
- ▶ Easily retrofitted to lock cases, even if lock cases have already been installed

#### ■ Security features

- ▶ Solid lock case design
- ▶ Double bolt stroke (5 mm and 10 mm)

#### ■ Technical data

- ▶ Compact installation dimensions: 52 x 54 mm
- ▶ Fixed to door or shutter with 3 screws
- ▶ Adjustable backset
- ▶ Lock case and bolt made of nickel-plated iron

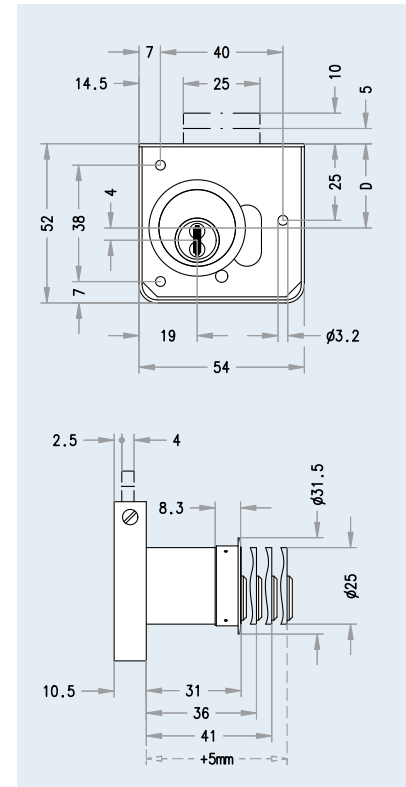

## Universal 4540 Espagnolette Lock For Furniture



### Ordering information

Universal 4540 with MRT/MRL 25

#### Applications and usage

Espagnolette lock for furniture such as

- ▶ Tall furniture doors and
  - ▶ Tall cupboard doors
- which require more than just locking due to their structure

#### Functional characteristics

- ▶ Backset: 40 mm
- ▶ Designed for full-length, 8 mm espagnolette
- ▶ Single rotation

#### Security features

- ▶ Solid lock case design
- ▶ Single rotation, 12 mm bolt stroke

#### Technical data

- ▶ Compact installation dimensions: 61 x 65 mm
- ▶ Fixed with four screws
- ▶ Lock case and bolt made of nickel-plated iron
- ▶ Designed for 8 mm rotary bars
- ▶ Flattened to 7 mm

#### Scope of supply

- ▶ Universal 4540 lock case
- ▶ Accessories:
- ▶ 2 hook bolts
- ▶ 1 angled strike plate
- ▶ 2 joints bolts
- ▶ Rod guide

#### Installation & operation

- ▶ Universal clamp fastening attached onto the lock case with side screws
- ▶ Easily retrofitted to lock cases, even if lock cases have already been installed

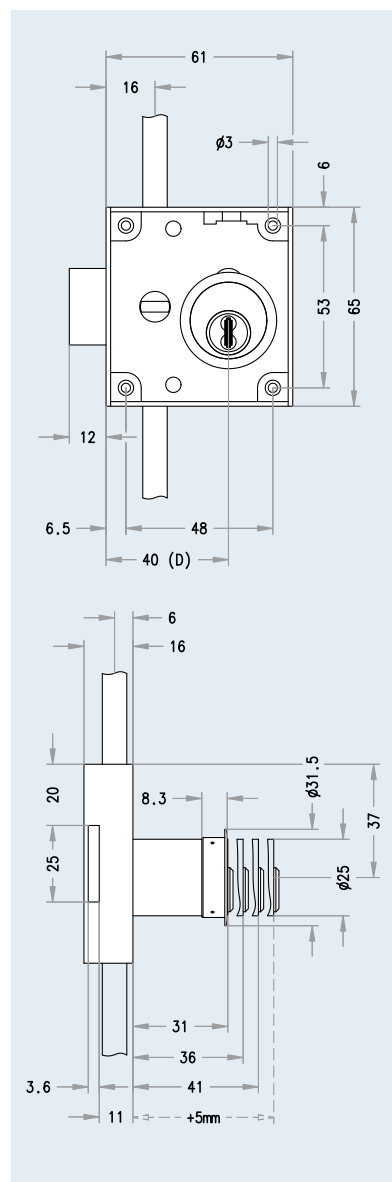

## Universal 4525 Espagnolette Lock For Furniture



### Ordering information

Universal 4525 (left/right specification necessary)

#### ■ Applications and usage

Espagnolette lock for furniture such as

- ▶ Lightweight furniture doors and
- ▶ Lightweight cupboard doors which require more than just locking due to their structure and which have already been predrilled for a 25 mm backset. Otherwise we recommend the Universal 4540 espagnolette lock!

#### ■ Functional characteristics

- ▶ Backset: 25 mm
- ▶ Designed for full-length, 7 mm espagnolette
- ▶ Single rotation locking function

#### ■ Security features

- ▶ Lightweight lock case design
- ▶ Single rotation 9 mm bolt stroke

#### ■ Technical data

- ▶ Compact installation dimensions: 46 x 83 mm
- ▶ Fixed with four screws
- ▶ Lock case and bolt made of nickel-plated iron
- ▶ Designed for full-length, 7 mm rotary bar flattened to 6 mm

#### ■ Scope of supply

- ▶ Universal 4525 lock case
- ▶ Accessories:
- ▶ 2 hook bolts
- ▶ 1 angled strike plate
- ▶ 2 joint bolts
- ▶ Rod guide

#### ■ Installation & operation

- ▶ Universal clamp fastening attached onto the lock case with a side screw

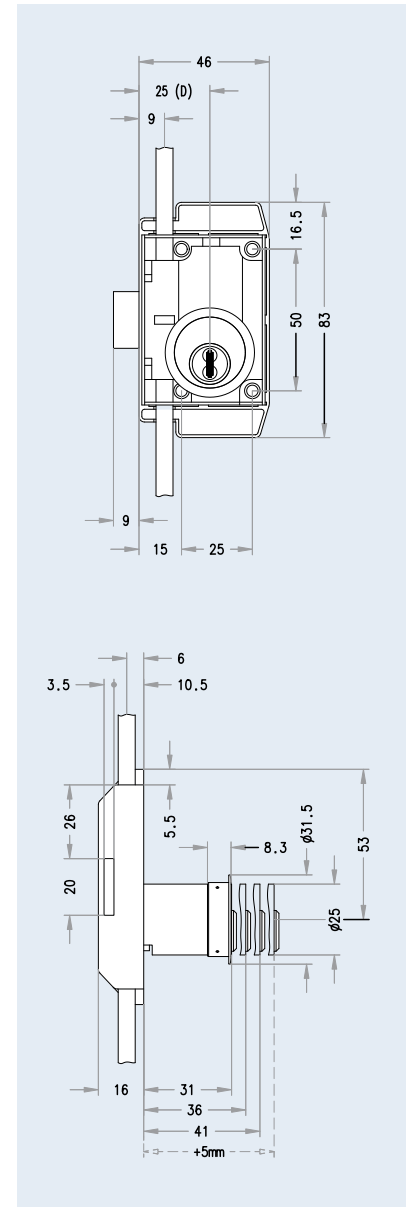

This is a discontinued product available only as long as stocks last!

## MAR Cabinet Bolt Lock



### Ordering information

MAR

#### Applications and usage

Cabinet bolt lock for simple locking of:

- ▶ Shutters
- ▶ Cabinet doors
- ▶ Cupboards

#### Functional characteristics

- ▶ Single rotation
- ▶ Designs: right/left and for shutters
- ▶ 10 mm bolt stroke

#### Security features

- ▶ Solid lock case design
- ▶ Single rotation, 10 mm bolt stroke

#### Technical data

- ▶ Lock case of bronzed iron

#### Scope of supply

- ▶ Lock case without accessories, without fastening material

#### Installation & operation

- ▶ Easy installation with four screws

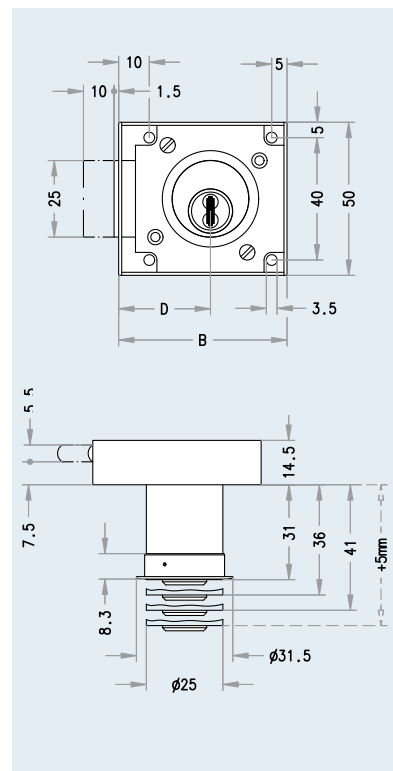

## MER Cabinet Bolt Lock



### Ordering information

- MER left/right and for shutter [backset]

### Applications and usage

Cabinet bolt lock for simple locking of:

- Shutters
- Cabinet doors
- Cupboards

### Functional characteristics

- For flush-mount in cabinet doors/shutters
- Single rotation
- Designs: right/left and for shutters
- 11 mm bolt stroke

### Security features

- Solid lock case design
- Single rotation, 11 mm bolt stroke

### Technical data

- Lock case of bronzed iron

### Scope of supply

- Lock case without accessories, without fastening material

### Installation & operation

- For installation into pre-milled lock recess

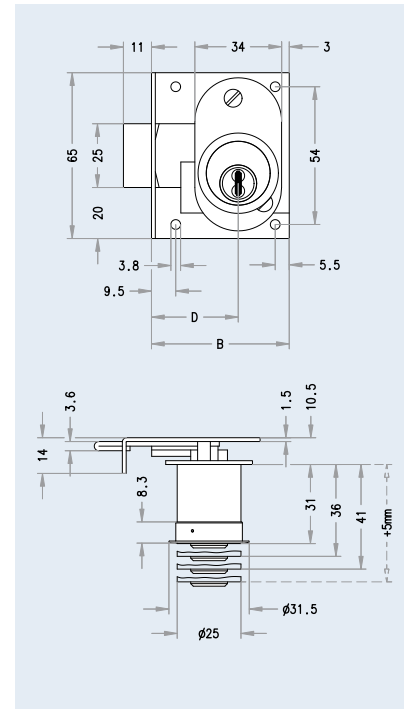

## SES Sliding Door Lock For Cabinet



### Ordering information

- SES

- Applications and usage**
  - For simple locking of sliding doors
- Scope of supply**
  - Lock case without strike plate, without accessories, without fixing material
- Functional characteristics**
  - For flush-mount in sliding doors
- Security features**
  - Lightweight lock case design
  - Sturdy hook latch
- Technical data**
  - Lock case of galvanized iron
- Installation & operation**
  - For installation into pre-milled lock recess
  - For wood thicknesses up to 32 mm

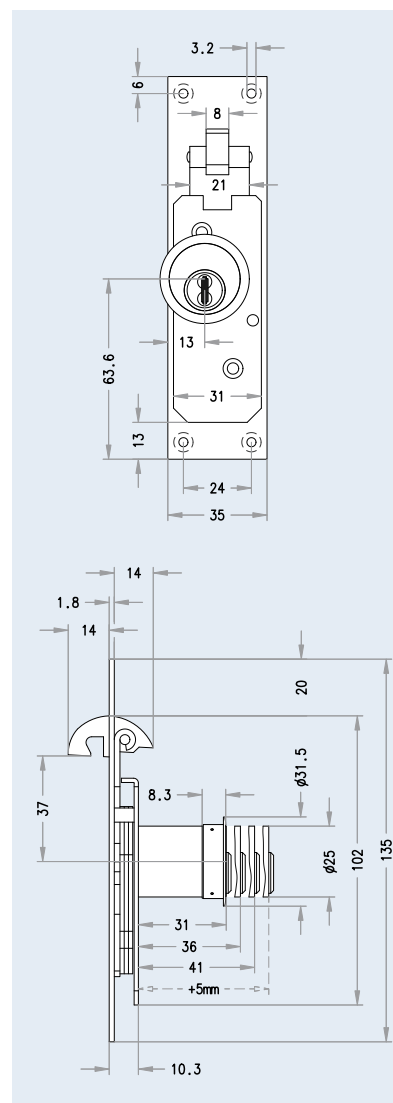

## 645 Furniture Lock With MR 22



### Ordering information

645 furniture lock with MR 22

#### Functional characteristics

- ▶ Lockable round furniture turn with grip recess
- ▶ Rear square plug to operate an espagnolette lock

#### Technical data

- ▶ Turn made of galvanized cast iron
- ▶ Outer diameter Ø 45 mm
- ▶ Designed for MR22 furniture round cylinder
- ▶ With 7 mm square plug

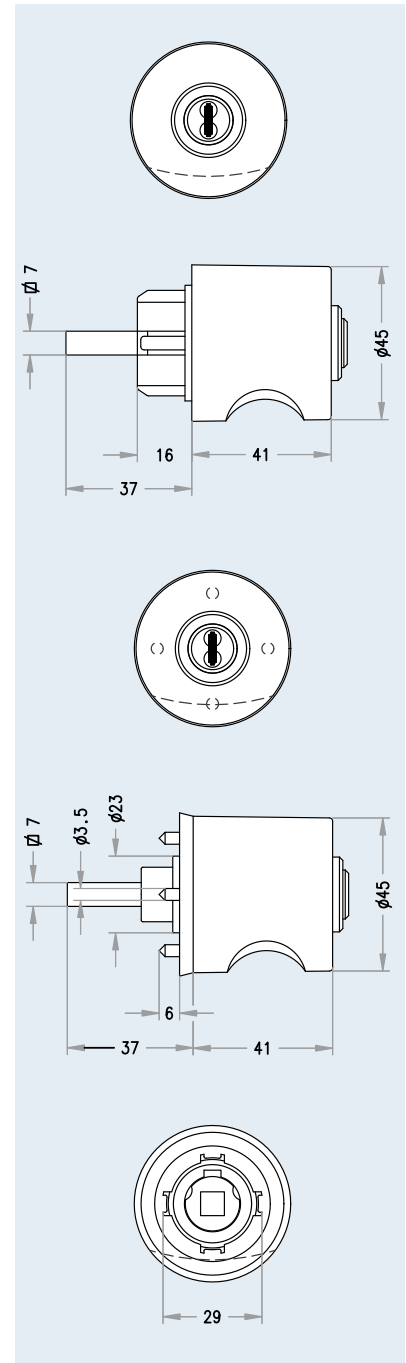



## AZ Rim Cylinder



### Ordering information

AZ [finish]

#### Applications and usage

- ▶ Designed for EVVA series K900 and K9000 security rim locks

#### Functional characteristics

- ▶ Locking rotation: 360 degrees
- ▶ Tail bar can be shortened at 5 mm spaced nicks

#### Security features

- ▶ Hard metal drilling protection in plug and body
- ▶ Steel balls provide drilling protection for the cylinder fixing screws
- ▶ Vertical key insertion for optimal scanning of locking elements

#### Technical data

- ▶ Cylinder body base material: brass
- ▶ Cylinder plug base material: brass
- ▶ All scanning elements coated with Triflon
- ▶ Tail bar for door thicknesses up to 50 mm
- ▶ Cylinder Ø 34 mm
- ▶ Rose Ø 50 mm

#### Scope of supply

- ▶ Round cylinder with rose and
- ▶ Two M5 x 40 fixing screws

#### Installation & operation

- ▶ Easy cylinder installation in prepared round hole
- ▶ Cylinder fixed through two M5 fastening holes
- ▶ Cylinder screws with pointed tips to make installation easier

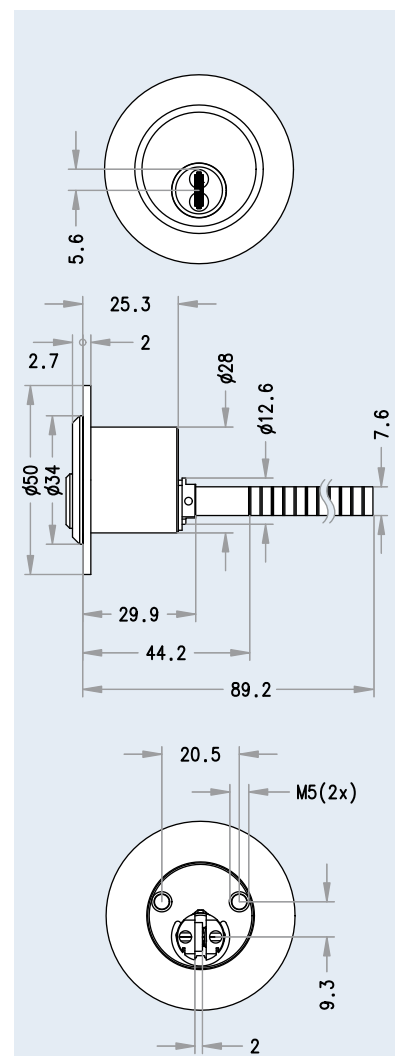

## AZG Rim Cylinder



### Ordering information

AZG [finish]

#### Applications and usage

For third-party products such as rim locks

#### Scope of supply

- ▶ Round cylinder with two M5 x 40 fixing screws

#### Functional characteristics

- ▶ Locking rotation: 360 degrees
- ▶ Tail bar can be shortened at 5 mm spaced nicks

#### Security features

- ▶ Hard metal drilling protection in plug and body
- ▶ Steel balls provide drilling protection for the cylinder fixing screws
- ▶ Vertical key insertion for optimal scanning of locking elements

#### Technical data

- ▶ Cylinder body base material: brass
- ▶ Cylinder plug base material: brass
- ▶ All scanning elements coated with Triflon
- ▶ Tail bar for door thicknesses up to 50 mm
- ▶ Cylinder Ø 34 mm
- ▶ Rose Ø 50 mm

#### Installation & operation

- ▶ Easy cylinder installation in prepared round hole
- ▶ Cylinder fixed through two M5 fastening holes
- ▶ Cylinder screws with pointed tips to make installation easier

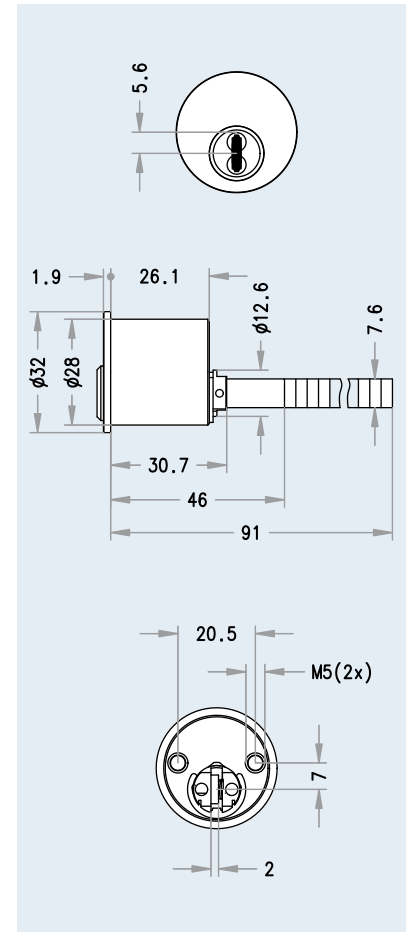

## AZI Rim Cylinder



### Ordering information

AZ [finish]

#### Applications and usage

- ▶ For rim locks of various manufacturers

#### Scope of supply

- ▶ Round cylinder with rose and
- ▶ Two M5 x 40 fixing screws

#### Functional characteristics

- ▶ Locking rotation: 360 degrees
- ▶ Tail bar can be shortened at 5 mm spaced nicks

#### Security features

- ▶ Hard metal drilling protection in plug and body
- ▶ Steel balls provide drilling protection for the cylinder fixing screws
- ▶ Vertical key insertion for optimal scanning of locking elements

#### Technical data

- ▶ Cylinder body base material: brass
- ▶ Cylinder plug base material: brass
- ▶ All scanning elements coated with Triflon
- ▶ Tail bar for door thicknesses up to 50 mm
- ▶ Cylinder Ø 34 mm
- ▶ Rose Ø 50 mm

#### Installation & operation

- ▶ Easy cylinder installation in prepared round hole
- ▶ Cylinder fixed through two M5 or M6 fastening holes
- ▶ Cylinder screws with pointed tips to make installation easier

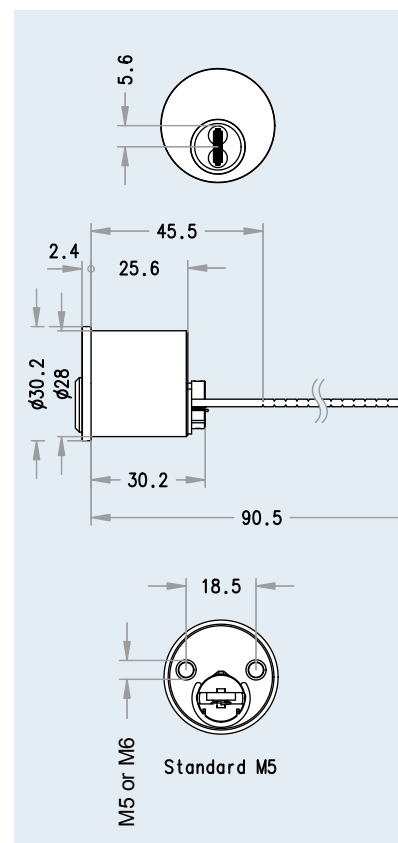

## AZ4050 Rim Cylinder



### Ordering information

AZ [finish]

#### Applications and usage

- ▶ Designed for rim locks .131, .132, .133, .136

#### Scope of supply

- ▶ Round cylinder with rose and two M5 x 40 fixing screws

#### Functional characteristics

- ▶ Locking rotation: 360 degrees
- ▶ Tail bar can be shortened at 5 mm spaced nicks

#### Security features

- ▶ Hard metal drilling protection in plug and body
- ▶ Steel balls provide drilling protection for the cylinder fixing screws
- ▶ Vertical key insertion for optimal scanning of locking elements

#### Technical data

- ▶ Cylinder body base material: brass
- ▶ Cylinder plug base material: brass
- ▶ All scanning elements coated with Triflon
- ▶ Tail bar for door thicknesses up to 50 mm
- ▶ Cylinder Ø 34 mm
- ▶ Rose Ø 50 mm

#### Installation & operation

- ▶ Easy cylinder installation in prepared round hole
- ▶ Cylinder fixed through two M5 fastening holes
- ▶ Cylinder screws with pointed tips to make installation easier

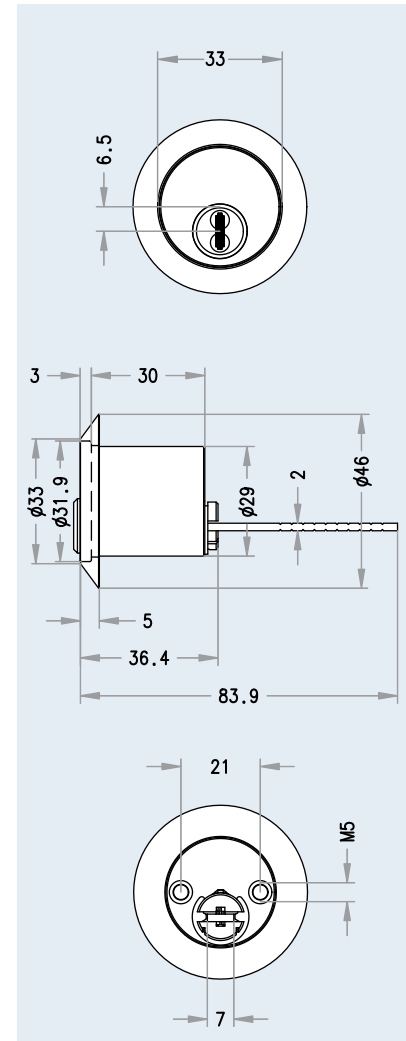

## AZ 4063 Rim Cylinder



### Ordering information

AZ [finish]

#### Applications and usage

- ▶ Designed for rim locks .133, .136

#### Scope of supply

- ▶ Round cylinder with rose and two M5 x 40 fixing screws

#### Functional characteristics

- ▶ Locking rotation: 360 degrees
- ▶ Tail bar can be shortened at 5 mm spaced nicks

#### Security features

- ▶ Hard metal drilling protection in plug and body
- ▶ Steel balls provide drilling protection for the cylinder fixing screws
- ▶ Vertical key insertion for optimal scanning of locking elements

#### Technical data

- ▶ Cylinder body base material: brass
- ▶ Cylinder plug base material: brass
- ▶ All scanning elements coated with Triflon
- ▶ Tail bar for door thicknesses up to 50 mm
- ▶ Cylinder Ø 34 mm
- ▶ Rose Ø 50 mm

#### Installation & operation

- ▶ Easy cylinder installation in prepared round hole
- ▶ Cylinder fixed through two M5 fastening holes
- ▶ Cylinder screws with pointed tips to make installation easier

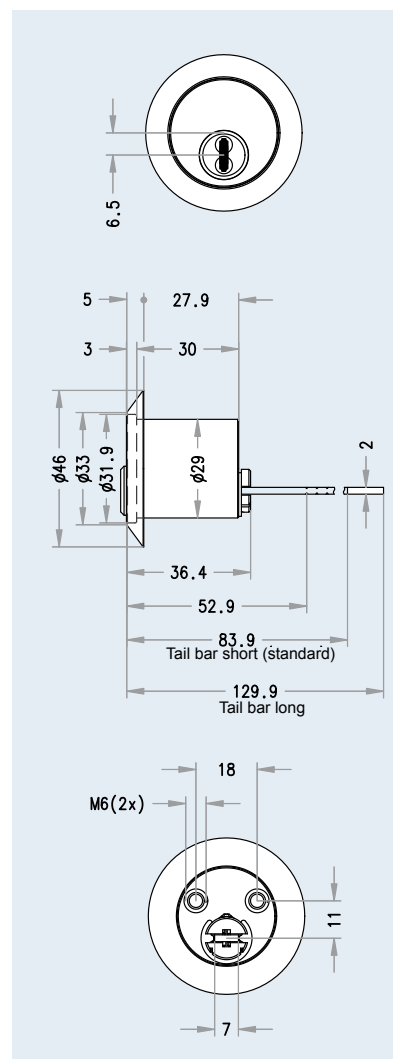

## PDZ Portal Double Cylinder



### Ordering information

PDZ cylinder length A/B, [finish], [security and usage options]

#### Applications and usage

- Portals with direct bolting
- Garden doors without mortise lock but with direct bolting

#### Functional characteristics

- Lockable on both sides with key
- Locking bolt  $\varnothing$  15 mm
- Bolt protrusion: 21.5 mm
- 15 mm stroke

#### Technical data

- Cylinder body base material: brass
- Cylinder plug base material: brass
- All scanning elements coated with Triflon
- Integrated locking bolt with
- 15 mm stroke

#### Scope of supply

- Locking cylinder without fixing screw, with locking bolt

#### Installation & operation

- Cylinder installation in a prepared, empty cylinder hole; designed for portal cylinder
- 3 possible M5 fastening variations

#### Security features

- Hard metal drilling protection in plug and body
- Vertical key insertion for optimal scanning of locking elements

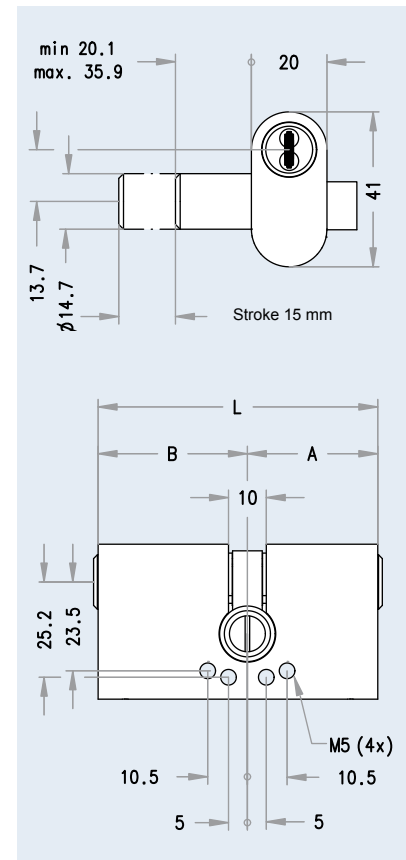

## PHZ Portal Half Cylinder



### Ordering information

PHZ cylinder length A, [finish], [security and usage options]

### Applications and usage

- ▶ Portals with direct bolting
- ▶ Garden doors without mortise lock but direct bolting
- ▶ Show window shields

### Functional characteristics

- ▶ Lockable with key on one side
- ▶ Locking bolt Ø 15 mm
- ▶ Bolt protrusion: 21.5 mm
- ▶ 15 mm stroke

### Security features

- ▶ Hard metal drilling protection in plug and body
- ▶ Vertical key insertion for optimal scanning of locking elements

### Scope of supply

- ▶ Locking cylinder without fixing screw, with locking bolt

### Technical data

- ▶ Cylinder body base material: brass
- ▶ Cylinder plug base material: brass
- ▶ All scanning elements coated with Triflon
- ▶ Integrated locking bolt with
- ▶ 15 mm stroke

### Installation & operation

- ▶ Cylinder installation in a prepared, empty cylinder hole for portal cylinder
- ▶ 3 possible M5 fastening variations

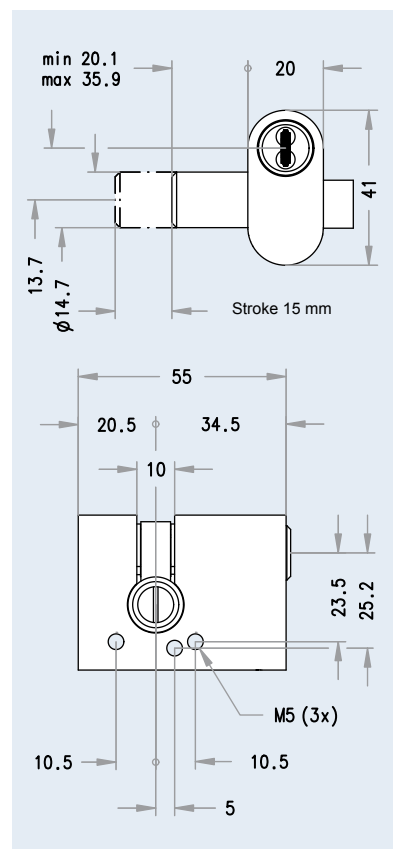

## EMZY MZT35i Electronic Motorised Cylinder

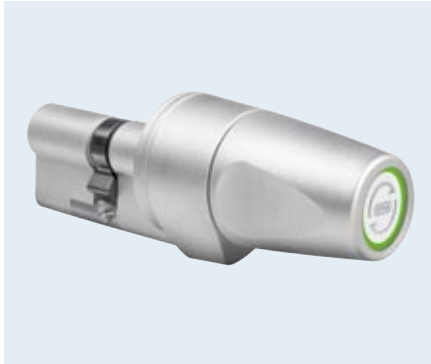

### Ordering information

- KZ cylinder length A/B, MZT35i (A=outer side; B=inner side (thumbturn side)) [security and usage options], [finish]

### Accessories

- "MCU MI"- micro controller for flush-mounted installation, without power adapter
- "MCU NT"- power adapter for standard supply for the "MCU MI"-micro controller
- EVKA cylinder connection cable, 10 m
- ERK1 door contact, incl. 1.5 m connection cable (white or brown)
- ERK4 door contact for metal doors with installation tray, incl. 1.5 m connection cable
- EKAO open cable transition, length 30 cm; incl. two end pieces (white, brown or chrome)
- ERKO bolt contact, incl. 2 m connection cable with switch-over contact
- ABDMK 35 thumbturn cover

### Applications and usage

- For mortise locks in accordance with DIN or ÖNORM
- For mortise locks in accordance with European technical standards
- Small backset for the motorised thumbturn on the thumbturn side, particularly suited for metal frame doors
- And for mortise locks with profile cylinder hole
- Minimal 35 mm backset for standard door installation in accordance with DIN 18101
- Motorised thumbturn with integrated button for simple operation
- Mechanical emergency release from the locking side
- Electronic control via external input units (such as code keypad, wall reader, ...)

### Scope of supply

- Electronic motorised cylinder
- Three 1.5 mm spacer discs
- Fixing screw

### Functional characteristics

- Electronically operated, cabled, motorised cylinder
- To lock/unlock locks
- Simple night-and-day mode switch
- Interactive learn mode for lock function (single and double turn locks)

### Security features

- Shape-matched spacer discs allow seamless transition from the thumbturn to the escutcheon

### Technical data

- Cylinder body base material: brass
- Cylinder plug base material: nickel silver
- All scanning elements coated with Triflon
- Cam home position: 30 degrees
- Cam width: 9.3 mm
- Modular cylinder design
- Motorised thumbturn torque about 1 Nm

### Installation & operation

- Easy cylinder installation in a prepared, empty cylinder hole
- Cylinder projecting length may not exceed 3 mm for security-relevant doors
- Cylinder fixed through a M5 fastening hole

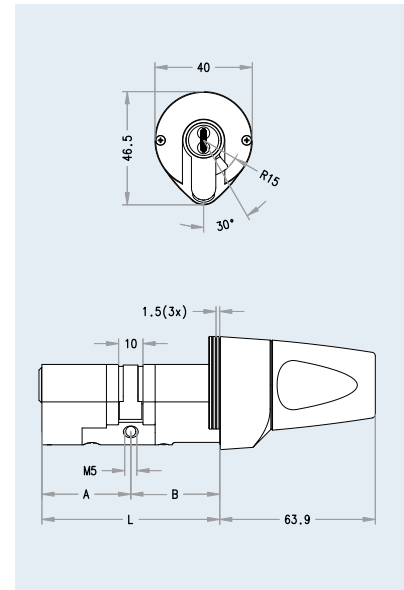





## ODZ Oval Double Cylinder



### Ordering information

- ▶ ODZ cylinder length A/B, [finish], [security and usage options]

### Applications and usage

- ▶ For mortise locks designed for British oval cylinders
- ▶ For house doors, connecting doors, flat entry doors, security doors, metal frame doors, ...

### Functional characteristics

- ▶ Lockable on both sides with key
- ▶ Cam rotation: 360 degrees
- ▶ Cam removal position: 30 degrees (from the short side)

### Security features

- ▶ Hard metal drilling protection in plug and body
- ▶ Vertical key insertion and optimal scanning of locking elements

### Technical data

- ▶ Cylinder body base material: brass
- ▶ Cylinder plug base material: nickel silver
- ▶ All scanning elements coated with Triflon
- ▶ Cam home position: 30 degrees
- ▶ Cam width: 9.3 mm
- ▶ Compact design

### Scope of supply

Locking cylinder with fixing screw

### Installation & operation

- ▶ Easy cylinder installation in a prepared, empty cylinder hole
- ▶ Cylinder projecting length may not exceed 3 mm for security-relevant doors
- ▶ Cylinder fixed through a M5 fastening hole

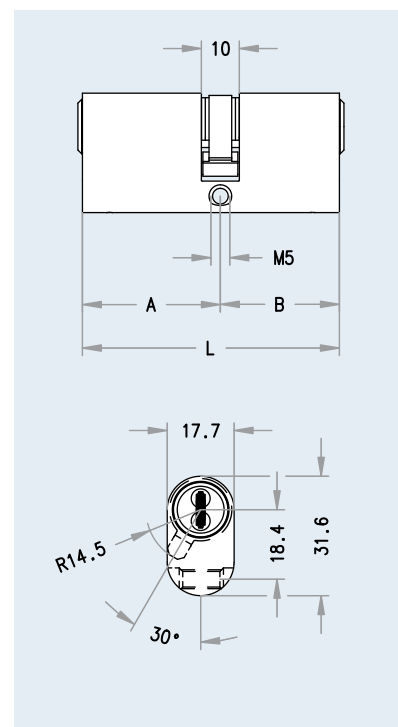

### Cylinder lengths

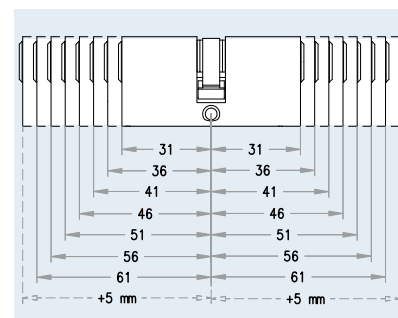

### Finishes

Finishes	Abbreviations	Standard	Surcharge
Polished brass	PB	●	
Satin nickel	NI	●	
Polished nickel	PN		○
Satin chrome	CR		○
Polished chrome	PC		○
Black	BL		○
Brown	BW		○
Satin brass	BR		○
PVD	PVD		○



## OKZ Oval Thumbturn Cylinder



### Ordering information

- KZ cylinder length A/B (A=outer side; B=inner side (thumbturn side)) [security and usage options]
- [finish]/[thumbturn design]
- When thumbturn design is not specified: AKN standard thumbturn

### Applications and usage

- For mortise locks designed for British oval cylinders
- For front doors, connecting doors, flat entry doors, security doors, metal frame doors, ...

### Functional characteristics

- Can be locked from the outside with a key
- Thumbturn on the inside to lock and unlock the door
- Cam rotation: 360 degrees

### Security features

- Hard metal drilling protection in the outside plug and body
- Vertical key insertion for optimal scanning of locking elements

### Technical data

- Cylinder body base material: brass
- Cylinder plug base material: nickel silver
- All scanning elements coated with Triflon
- Cam home position: 30 degrees
- Cam width: 9.3 mm
- Compact design
- Finishes: satin nickel plated, satin brushed, polished lacquer

### Scope of supply

- Locking cylinder with thumbturn and fixing screw

### Installation & operation

- Easy cylinder installation in a prepared, empty cylinder hole
- Cylinder projecting length may not exceed 3 mm for security-relevant doors
- If required, inside thumbturn can be removed with a tool and replaced with another EVVA thumbturn
- Cylinder fixed through a M5 fastening hole

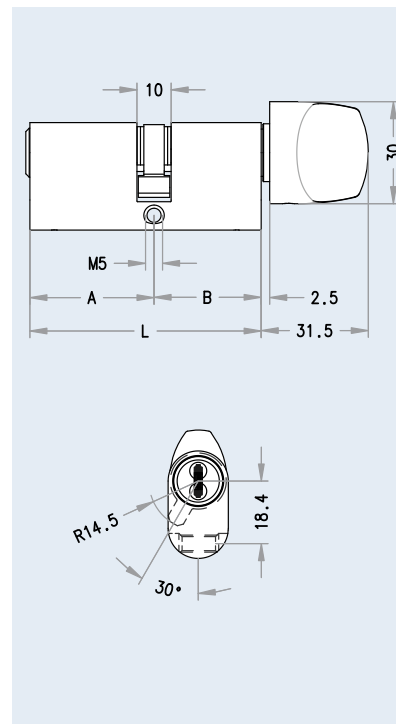

### Cylinder lengths

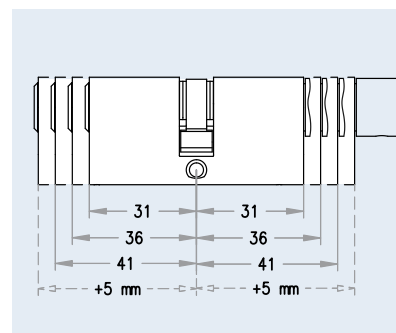

### Finishes

Finishes	Abbreviations	Cylinder	AKN, KKN, FKN	RKN, MKN	OKN, OKNA	GKN
Polished brass	PB	●	●	●	●	●
Satin nickel	NI	●	●	●	●	●
Polished nickel	PN	○	○	○	○	○
Satin chrome	CR	○	○	○	○	○
Polished chrome	PC	○	○	○	○	○
Black	BL	○	○	○	○	○
Brown	BW	○	○	○	○	○
Satin brass	BR	○	○	○	○	○
PVD	PVD	○	○	○	○	○
RAL colour	RAL					○



## OHZ Oval Half Cylinder



### Ordering information

- ▶ UHZ cylinder length A, [finish], [security and usage options]

### Applications and usage

- ▶ For single-turn or multi-turn mortise locks and other locks designed for British oval cylinders
- ▶ Garage doors and roller shutters fastened at the side

### Functional characteristics

- ▶ Can be operated with a key on one side
- ▶ Cam rotation: 360 degrees
- ▶ Cam removal position: 45 degrees
- ▶ Cam can be set to 8 positions (45°, 90°, 135°, 180°, 225°, 270°, 315°, 360°)

### Security features

- ▶ Hard metal drilling protection in plug and body

### Technical data

- ▶ Cylinder body base material: brass
- ▶ Cylinder plug base material: nickel silver
- ▶ All scanning elements coated with Triflon
- ▶ Cam home position: 45 degrees (changeable)
- ▶ Cam width: 9.3 mm
- ▶ Compact design

### Scope of supply

- ▶ Half cylinder with fixing screw

### Installation & operation

- ▶ Easy cylinder installation in a prepared, empty cylinder hole
- ▶ Cylinder should be flush with the escutcheon or rose
- ▶ Cylinder fixed through a M5 fastening hole

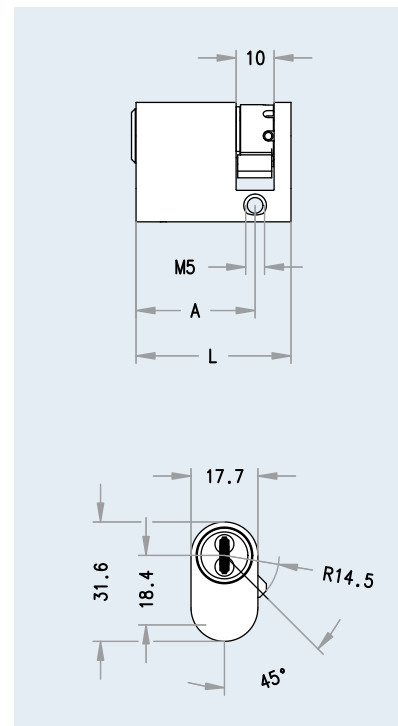

### Cylinder lengths

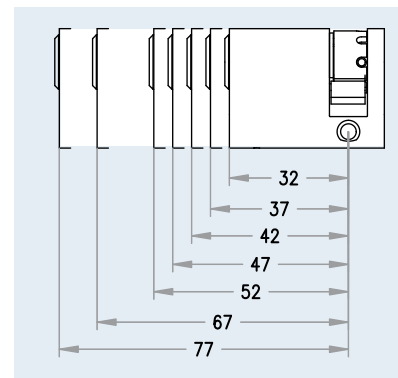

### Finishes

Finishes	Abbreviations	Standard	Surcharge
Polished brass	PB	●	
Satin nickel	NI	●	
Polished nickel	PN		○
Satin chrome	CR		○
Polished chrome	PC		○
Black	BL		○
Brown	BW		○
Satin brass	BR		○
PVD	PVD		○



## Rim Cylinder Type „M“ Mortise



### Ordering Information

- Mortise size [L], [Finish]

### Applications and usage

- For mortise locks for rim cylinders 29,2 x 32 G/1"
- Standard Adams-Rite cam
- Other cams on request

### Functional characteristics

- Locking rotation: 360 degrees

### Security features

- Hard metal drilling protection in the plug
- Vertical key insertion for optimal scanning of locking elements

### Technical data

- Cylinder body base material: brass
- Cylinder plug base material: brass
- All scanning elements coated with Triflon
- Cylinder diameter: 33.9 mm
- Cam fixed through 2 diagonal screws
- Other screws on request

### Scope of supply

- Round cylinder without rose, without fixing screw

### Installation & operation

- Screw the cylinder in the foreseen mortise lock with inside thread
- Fixing with set screw from mortise lock

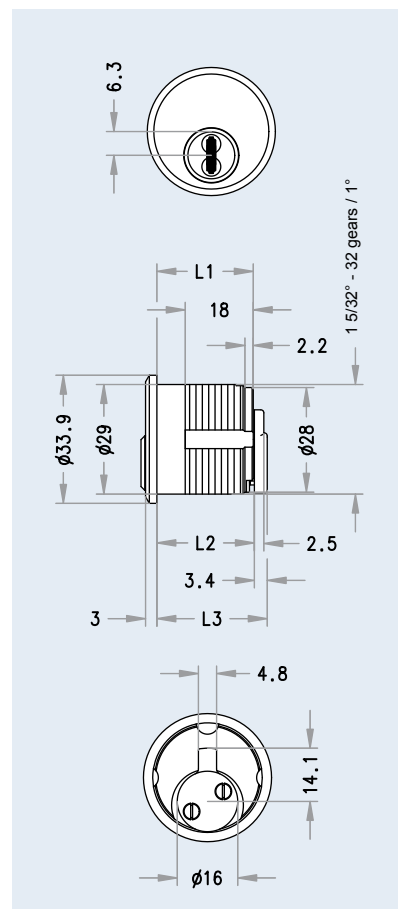



## SKA Scandinavian Outside Cylinder



### Ordering information

- SKA [finish], [security and usage options]

### Applications and usage

- For mortise locks designed for Scandinavian cylinders
- For use on house doors, connecting doors, flat entry doors, security doors, metal frame doors,...

### Functional characteristics

- Can be locked on one side with the key
- Short horizontal tail bar
- Locking rotation: 360 degrees

### Security features

- Hard metal drilling protection in plug and body
- Vertical key insertion for optimal scanning of locking elements

### Technical data

- Cylinder body base material: brass
- Cylinder plug base material: brass
- All scanning elements coated with Triflon
- Horizontal tail bar

### Scope of supply

- Locking cylinder

### Installation & operation

- Easy cylinder installation in a prepared, empty cylinder hole
- Cylinder fixed at rear

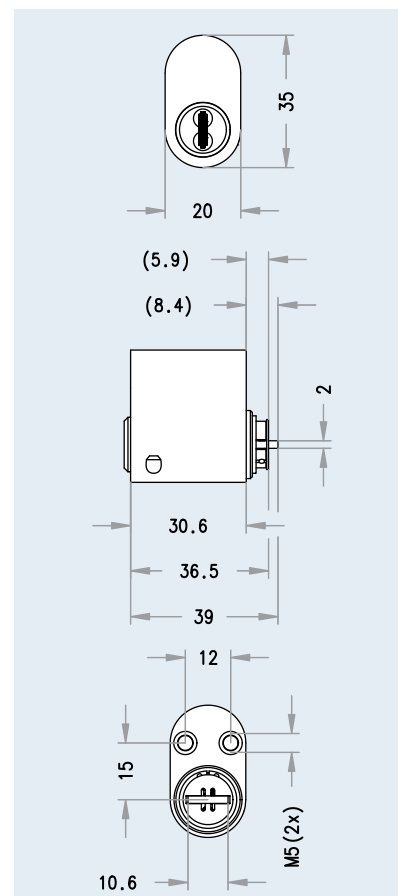

### Finishes

Finishes	Abbreviations	Standard	Surcharge
Polished brass	PB	●	
Satin nickel	NI	●	
Polished nickel	PN		○
Satin chrome	CR		○
Polished chrome	PC		○
Black	BL		○
Brown	BW		○
Satin brass	BR		○
PVD	PVD		○

## SKA/N Scandinavian Outside Cylinder (Norway Type)



### Ordering information

- SKA/N [finish], [security and usage options]

### Applications and usage

- For mortise locks designed for Scandinavian cylinders
- For use on house doors, connecting doors, flat entry doors, security doors, metal frame doors,...

### Functional characteristics

- Can be locked on one side with the key
- Short horizontal tail bar
- Locking rotation: 360 degrees

### Security features

- Hard metal drilling protection in plug and body
- Vertical key insertion for optimal scanning of locking elements

### Technical data

- Cylinder body base material: brass
- Cylinder plug base material: brass
- All scanning elements coated with Triflon
- Horizontal tail bar

### Scope of supply

- Locking cylinder without screws

### Installation & operation

- Easy cylinder installation in a prepared, empty cylinder hole
- Lateral cylinder fixation 3/16"

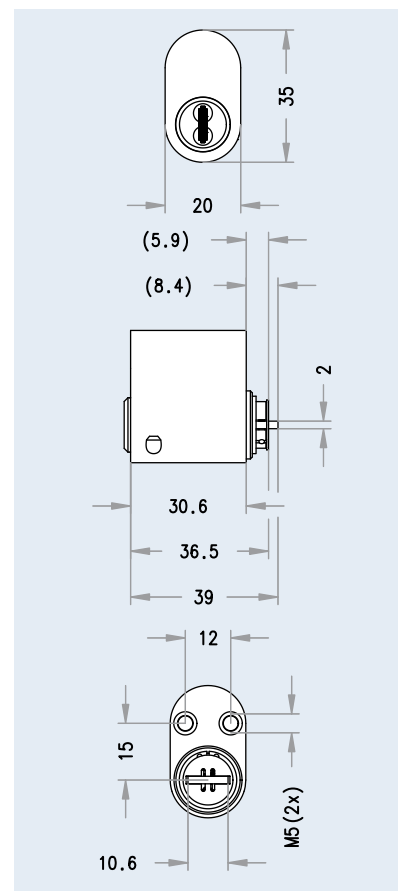

### Finishes

Finishes	Abbreviations	Standard	Surcharge
Polished brass	PB	●	
Satin nickel	NI	●	
Polished nickel	PN		○
Satin chrome	CR		○
Polished chrome	PC		○
Black	BL		○
Brown	BW		○
Satin brass	BR		○
PVD	PVD		○

## SKDZ Scandinavian Double Cylinder



### Ordering information

- ▶ SKDZ [finish], [security and usage options]

### Applications and usage

- ▶ For mortise locks designed for Scandinavian cylinders
- ▶ For use on the inside area of house doors, connecting doors, flat entry doors, security doors, metal frame doors,...

### Functional characteristics

- ▶ Can be locked on one side with the key
- ▶ Short horizontal tail bar
- ▶ Locking rotation: 360 degrees
- ▶ To be used only in combination with a second SKDZ

### Security features

- ▶ Vertical key insertion for optimal scanning of locking elements

### Technical data

- ▶ Cylinder body base material: brass
- ▶ Cylinder plug base material: brass
- ▶ All scanning elements coated with Triflon
- ▶ Horizontal tail bar

### Installation & operation

- ▶ Easy cylinder installation in a prepared, empty cylinder hole

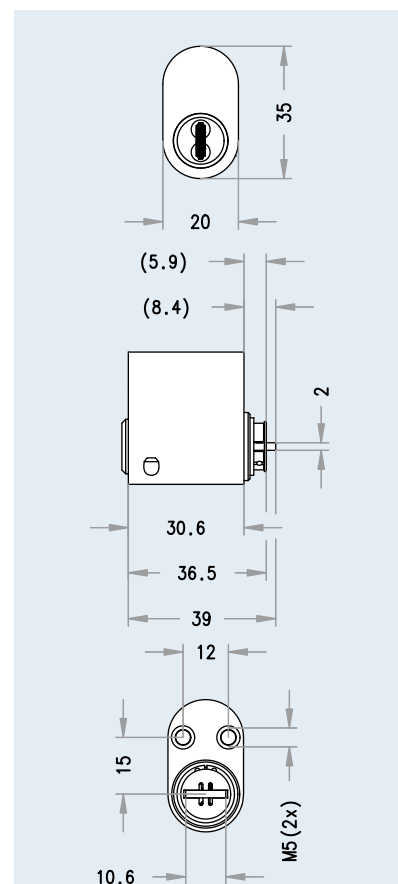

### Finishes

Finishes	Abbreviations	Standard	Surcharge
Polished brass	PB	●	
Satin nickel	NI	●	
Polished nickel	PN		○
Satin chrome	CR		○
Polished chrome	PC		○
Black	BL		○
Brown	BW		○
Satin brass	BR		○
PVD	PVD		○





## SKI Scandinavian Inside Cylinder



### Ordering information

- SKI [finish], [security and usage options]

### Applications and usage

- For mortise locks designed for Scandinavian cylinders
- For use on the inside area of house doors, connecting doors, flat entry doors, security doors, metal frame doors,...

### Functional characteristics

- Can be locked on one side with the key
- Short horizontal tail bar
- Locking rotation: 360 degrees
- Suitable as second part for Scandinavian double cylinder (SKA+SKI)

### Security features

- Vertical key insertion for optimal scanning of locking elements

### Technical data

- Cylinder body base material: brass
- Cylinder plug base material: brass
- All scanning elements coated with Triflon
- Horizontal tail bar

### Scope of supply

- Locking cylinder with 2 fixing screws

### Installation & operation

- Easy cylinder installation in a prepared, empty cylinder hole
- Continuous bores for screw connection with outside cylinder

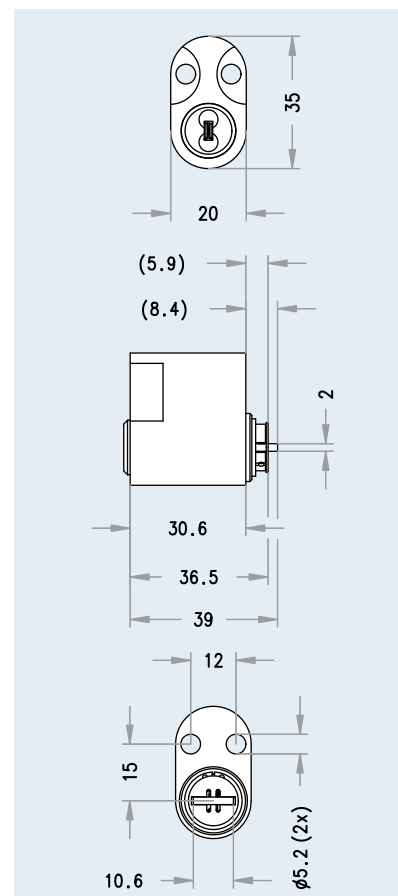

### Finishes

Finishes	Abbreviations	Standard	Surcharge
Polished brass	PB	●	
Satin nickel	NI	●	
Polished nickel	PN		○
Satin chrome	CR		○
Polished chrome	PC		○
Black	BL		○
Brown	BW		○
Satin brass	BR		○
PVD	PVD		○



## KZ Thumbturn Cylinder With Adaptable Thumbturn Axis

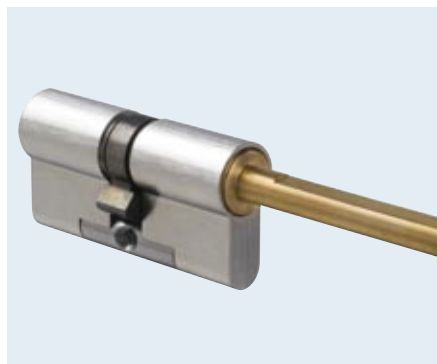

### Ordering information

- ▶ KZ cylinder length A/B (A=outer side; B=inner side (thumbturn side)) [security and usage options]
- ▶ [finish]/[thumbturn design]

### Applications and usage

- ▶ For mortise locks in accordance with DIN or ÖNORM
- ▶ For mortise locks in accordance with European technical standards
- ▶ For house doors, connecting doors, flat entry doors, security doors, metal frame doors, ...
- ▶ For break-in resistant doors of resistance class Wz6

### Functional characteristics

- ▶ Can be locked on the outside with a key
- ▶ Thumbturn on the inside to lock and unlock the door
- ▶ Cam rotation: 360 degrees

### Security features

- ▶ Hard metal drilling protection in the outside plug and body
- ▶ Pulling protection through chrome-nickel connecting rod
- ▶ Vertical key insertion for optimal scanning of locking elements

### Technical data

- ▶ Cylinder body base material: brass
- ▶ Cylinder plug base material: nickel silver
- ▶ All scanning elements coated with Triflon
- ▶ Cam home position: 30 degrees
- ▶ Cam width: 9.3 mm
- ▶ Modular cylinder design
- ▶ Finishes: satin nickel plated, satin brushed, polished lacquer

### Scope of supply

- ▶ Locking cylinder without thumbturn, with fixing screw

### Installation & operation

- ▶ Easy cylinder installation in a prepared, empty cylinder hole
- ▶ Cylinder projecting length may not exceed 3 mm for security-relevant doors
- ▶ Elongated thumbturn axis with flatterring for thumbturn fixation with screws
- ▶ If required, inside thumbturn can be removed with a tool and replaced with another EVVA thumbturn
- ▶ Cylinder fixed through a M5 fastening hole

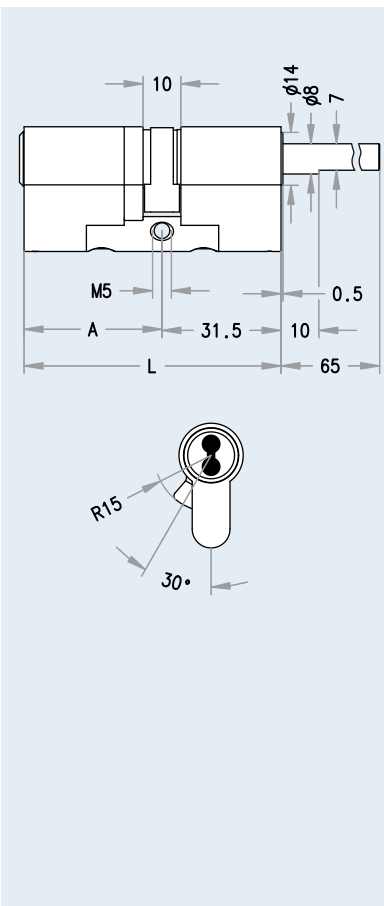



## Cam types

### Applications and usage

- For cam locks (plate installation cylinders) MB19, MB23, MB30, ZB27, ZB27K, MB20GT, MB23G, MB23GT, MB30MB, MB30

**Attention: Cam types do not apply to MRH22 and SRZ22**

**5088**

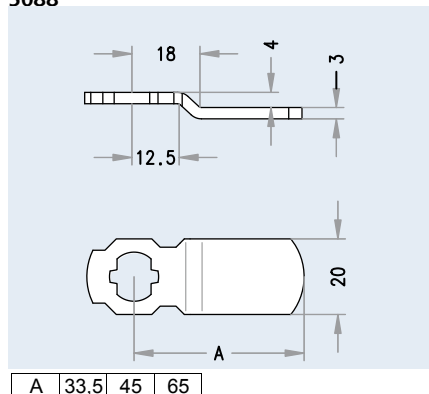

**5092**

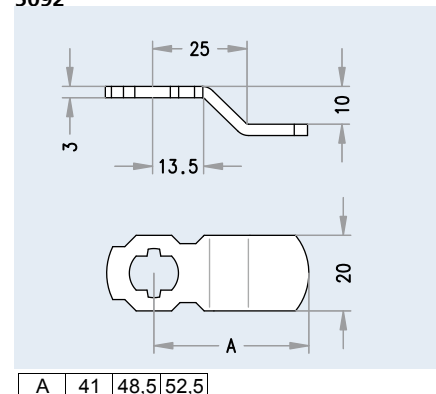

**5072**

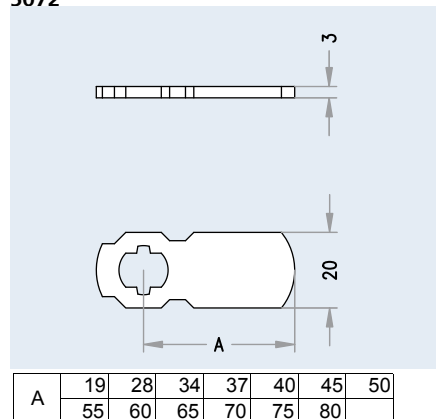

**5089**

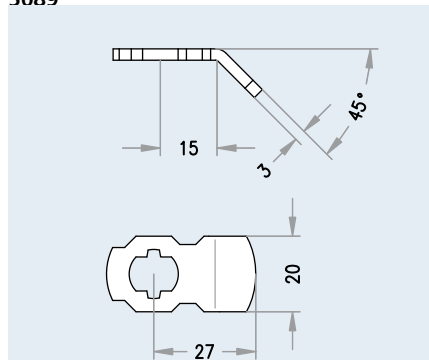

**5094**

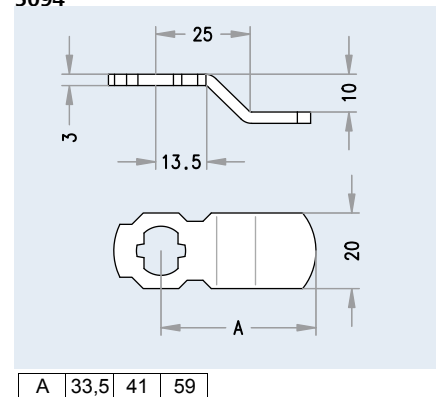

**5073**

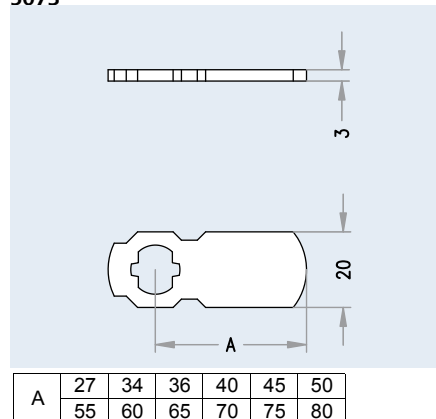

**5090**

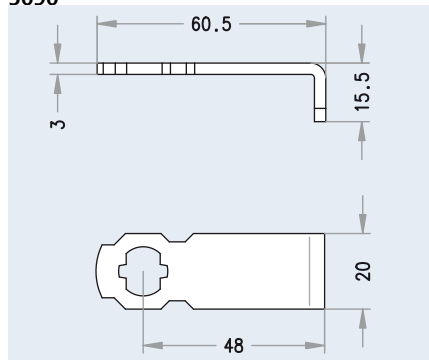

**5095**

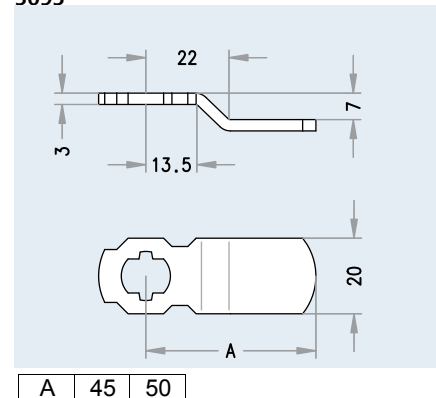

**5087**

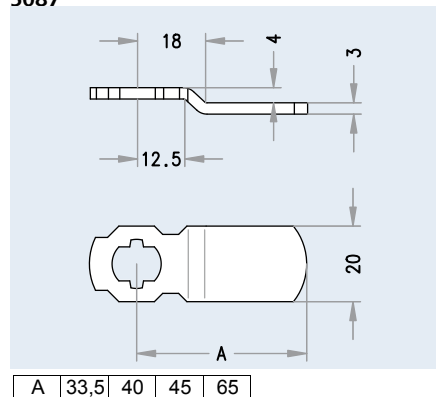

**5091**

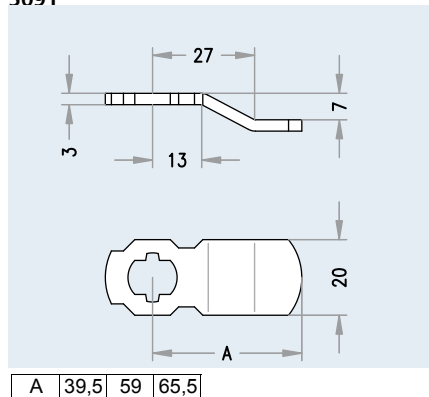

**5096**

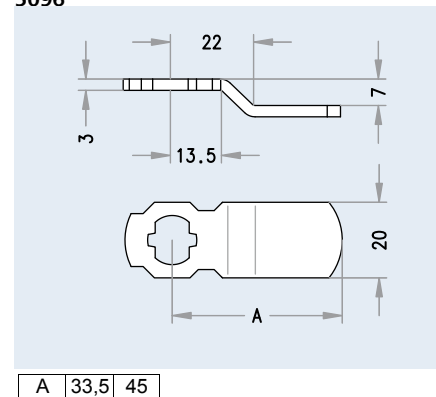

## Cam types

5097

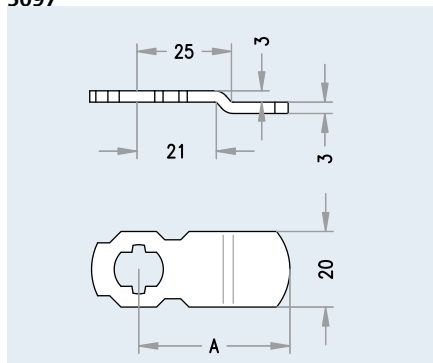

A	33,5	37	40	45	50	55	70
---	------	----	----	----	----	----	----

5099D

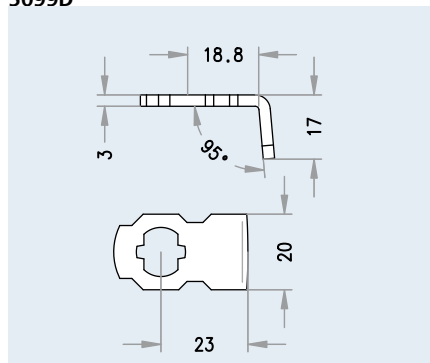

EVVA, storage and Zwick mailbox systems

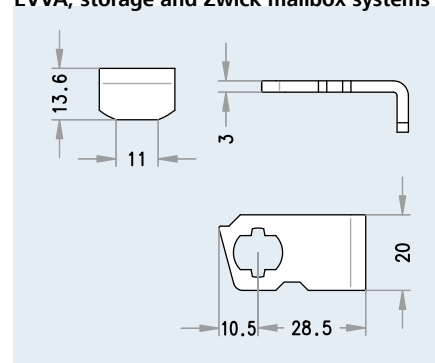

5097S

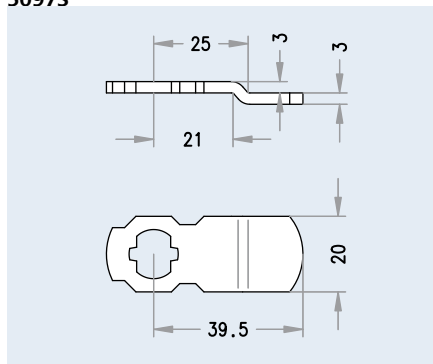

Hook

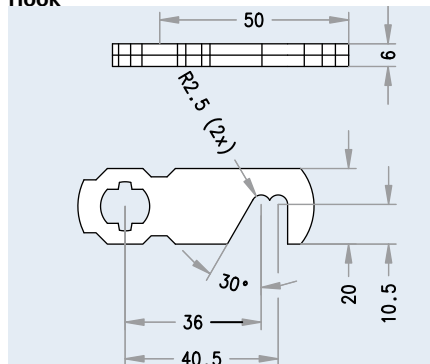

Special mailbox systems

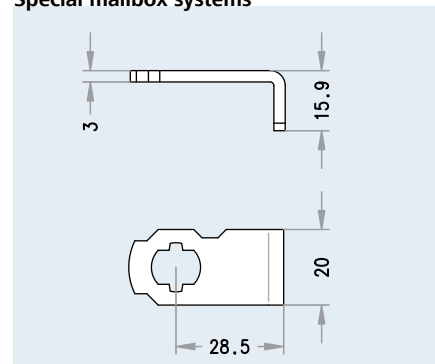

5098

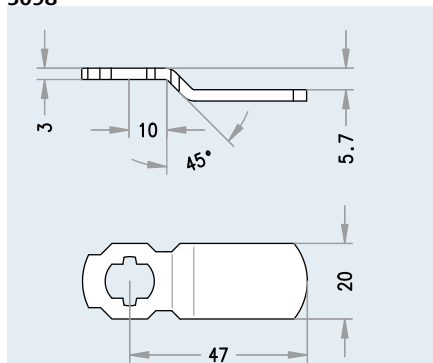

Hook2

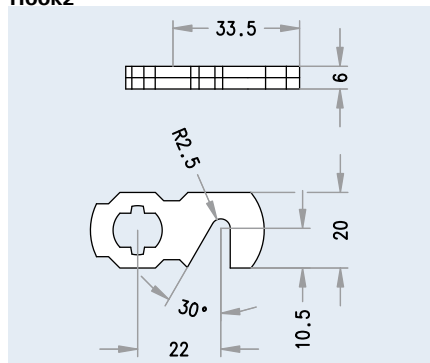

RENZ3

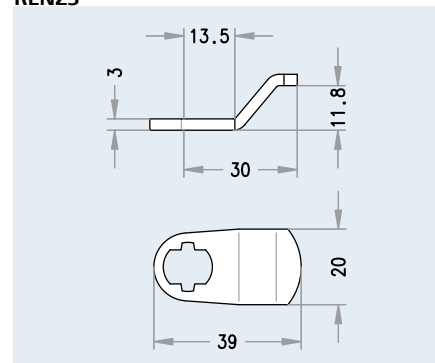

5099C

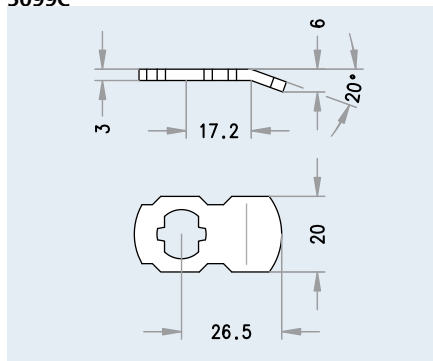

NSK

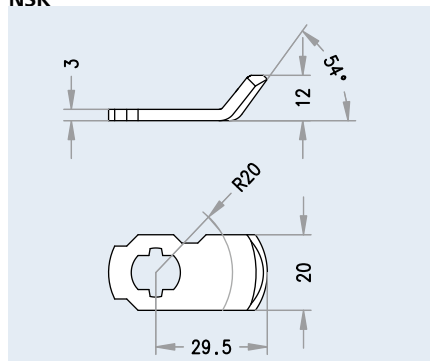

RENZ D

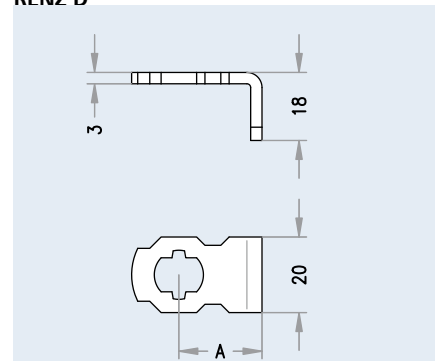

A	22	28
---	----	----

## B1 Construction Key



### Ordering information

- ▶ B1

### Technical data

- ▶ The conical, square-shaped key tip ensures doors can be opened and closed easily.
- ▶ Cam for profile cylinder hole
- ▶ 7 to 10 mm square-shaped pin
- ▶ Cylinder measuring unit

### Material used

- ▶ Composite

## B2 Construction Key



### Ordering information

- ▶ B2

### Technical data

- ▶ The conical, square-shaped key tip ensures doors can be opened and closed easily.
- ▶ Square-shaped pin lock key, 6, 7 and 8 mm
- ▶ Cam for profile cylinder hole
- ▶ Square-shaped pin, 6 to 10 mm
- ▶ Hexagonal key, 3 mm

### Material used

- ▶ Composite

## B3 Construction Key With Cylinder Measuring Unit



### Ordering information

- ▶ B3

### Applications and usage

- ▶ The conical, square-shaped key tip ensures doors can be opened and closed easily.
- ▶ 6, 7 and 8 mm square-shaped pin lock key
- ▶ Cam for profile cylinder hole
- ▶ Square-shaped pin between 7 and 10 mm
- ▶ Hexagonal key, 3 mm
- ▶ Cylinder measuring unit

### Material used

- ▶ Die-cast, nickel plated

## B4 Multi-Tool Construction Key



### Ordering information

- ▶ B4

### Applications and usage

- ▶ External square socket key, AF width 7 + 8 mm
- ▶ External triangular socket key, 8 mm
- ▶ Pozidrive screw bit no. 2
- ▶ Countersunk screw bit size 3
- ▶ Radiator bleed key, AF width 5 mm
- ▶ Measurement scale up to 40 mm
- ▶ Round cylinder carrier, nominal  $\varnothing$  22 mm
- ▶ Bottle opener on carrier
- ▶ Square drive, AF width 7 / 8 / 9 / 10 mm
- ▶ Hexagonal square drive, AF width 3 mm

### Material used

- ▶ Die-cast, satin nickel plated

## Multi-Spray



### ■ Applications and usage

- ▶ Indispensable for house and garden, at the workplace, for vehicles, sport and leisure equipment, industry and agriculture, all kinds of machines, locks as well as all electrical devices.

### ■ Security features

- ▶ Free of silicone, hence it does not gum susceptible materials

### ■ Functional characteristics

- ▶ Eliminates squeaking and creaking
- ▶ Helps to jump start damp motors
- ▶ Loosens jammed components
- ▶ Protects against corrosion
- ▶ Cleans tough dirt and stains

### ■ Designs

- ▶ Multi-Spray 200 ml
- ▶ Multi-Spray 400 ml

## Resistorx Screws



### ■ Applications and usage

- ▶ Tamper-proof cylinder fixing screw

### ■ Security features

- ▶ Optimum protection against tampering with special Resistorx
- ▶ Countersunk head with TX35

### ■ Designs

- ▶ Nirosta, stainless steel

### Ordering information

- ▶ Resistorx

**A ▶** EVVA Sicherheitstechnologie GmbH  
Wienerbergstraße 59-65 | A-1120 Wien  
T +43 1 811 65-0 | F +43 1 812 20 71  
office-wien@evva.com | www.evva.com

EVVA Sicherheitssysteme GmbH  
Ing.-Julius-Raab-Str. 2 | A-2721 Bad Fischau-Brunn  
T +43 2622 42288 | F +43 2622 42288-34  
office-badfischau@evva.com | www.evva.com

**D ▶** EVVA Sicherheitstechnik GmbH  
Höfgeshofweg 30 | D-47807 Krefeld  
T +49 2151 37 36-0 | F +49 2151 37 36-5635  
office-krefeld@evva.com | www.evva.de

EVVA Sicherheitstechnik GmbH  
Föpplstraße 15 | D-04347 Leipzig  
T +49 341 234 090-5 | F +49 341 234 090-5760  
office-leipzig@evva.com | www.evva.de

EVVA Sicherheitstechnik GmbH  
Kieffholzstraße 287 | D-12437 Berlin-Treptow  
T +49 30 536 017-0 | F +49 30 536 017-5722  
office-berlin@evva.com | www.evva.de

